



ROAD SAFETY SOLUTIONS.

# WE POINT THE WAY

TRAFFIC MANAGEMENT PRODUCTS  
LIGHT & LAMPS  
2018/2019



# SAFETY IS OUR MISSION



Dear customer, partners and prospective customers,

In your business, you depend on the right materials every single day. You depend on quality that is worth the price, functionality that is tried and tested, and, of course, technical characteristics that meet the legal norms. As one of the world's technology and industry leaders, we develop and manufacture products that meet or exceed these requirements. From beacons, safety barriers and traffic cones to warning lamps and guidance systems. With decades of experience and the knowledge of competent engineers, we point the way on the road and in the marketplace, as well. This is our job, that is our mission. But don't take our word for it, take a look at our product range for traffic management products, light and lamps and see for yourself.

**KARL-FRIEDRICH FANDRICH**  
*Head of Human Resources and Finance and Shareholder*

**JAN VOGT**  
*Commercial manager and authorized representative*

**DIETER WADE**  
*Managing Director and Shareholder*

**KAI FREUND**  
*Technical manager and authorized representative*



## Your benefits

<b>Quality manufacturing</b>	<b>6</b>
<b>Test standards</b>	<b>8</b>
<b>Individualisation</b>	<b>10</b>
<b>Service and know-how</b>	<b>11</b>
<b>Sales Germany</b>	<b>12</b>
<b>Sales International</b>	<b>14</b>

## Traffic management products

<b>Beacons</b>	<b>18</b>
Safety Beacon	20
Reversible Beacon WeBaNi 40	21
Standard Beacon	22
Reversible Beacon WeBaNi 60	23
<b>Safety barriers</b>	<b>24</b>
Mobile Plastic Safety Barrier Pro-S	26
Mobile Plastic Safety Barrier Pro-G	27
Mobile Plastic Safety Barrier Flex	28
Mobile Plastic Barrier	29
Accessories for Safety Barriers	30
<b>Base plates</b>	<b>32</b>
Base plate TL 56 K1	34
Base plate K1	35
Base plate light	36
Base plate Kompakt K1	37
<b>Traffic guidance systems</b>	<b>38</b>
Quick Marker	40
Small Beacon (Indicator)	41
Tornado 75-Flex	42
Base Plate for Tornado 75-Flex	43
<b>Folding Beacon NiColl<sup>75</sup></b>	<b>44</b>
<b>Folding Traffic signs</b>	<b>48</b>
<b>Traffic Cones</b>	<b>52</b>
Traffic Cones (according to German standards)	54
Traffic Cones	55

## Light and Lamps

<b>Warning Lamps</b>	<b>60</b>
BakoLight LED	62
Euro-Nitra LED	63
Konstant-Norm LED	64
MonoLight LED	65
Nitra LED	66
<b>Guide Light Systems</b>	<b>68</b>
Sequential Direction Light Set	70
Cascade Light Set 200 LED	71
BakoTaper LED-Flash	72
TaperLamp 626-C/626-C Plus LED	73
<b>Rapid securing</b>	<b>74</b>
City Flash 63/S LED	76
Star-Flash LED 610	77
Star-Flash LED 620	78
Star-Flash LED Type 627	79
Pin Lamp Type 62/5	80
Traffic Cone Lamp Type 620-LK	81
Traffic Cone Lamp 220 LED	82
Traffic Cone Lamp 340 LED	83
Traffic Cone Lamp Type S-LED	84
Synchros	85
<b>Advance Warning Lamps</b>	<b>86</b>
Warning Lamp Zyklus 220	88
Warning Lamp Zyklus 220 Flash	89
Warning Lamp 340 LED L9H	90
Warning Lamp 340 LED Flash L9M	91
<b>Traffic Light System LZA 500</b>	<b>92</b>
Traffic Light System LZA 500-LED	94
LED-Counter for LZA 500-LED	95
<b>Hand Lamps</b>	<b>96</b>
Hand Lamp LED	98
Hand Lamp Halogen	99
<b>Batteries and accumulators</b>	<b>100</b>
Premium Batteries	102
Konstant Batteries	103
Rechargeable Batteries and Batteries	104
Chargers for Batteries	105
<b>Imprint</b>	<b>106</b>

# QUALITY IS OUR STRENGTH

We develop and produce all our products in-house. This enables us to maintain complete process control and ensure a consistently high quality.

In our factories at the headquarters in Tönning, roughly 170 employees manufacture safety for the world's roads. Steel and plastic elements come from our own production facilities and are expertly assembled after extensive testing. Any parts we purchase are also subject to strict testing. And before a product

with a mechanical or electronic function leaves our factory, our specialists review it thoroughly. After that it continues to go all over the world with a powerful distribution fleet. We owe this uncompromising quality to our self-image and the responsibility we take for road safety.



Our quality management has been certified since 1995 according to **DIN EN ISO 9001** and our environmental management since 2014 according to **DIN EN ISO 14001**.



# HIGH QUALITY IS OUR STANDARD

## When safety comes from responsibility

When it comes to mobile traffic safety, planning and selecting the right materials are critical. When you choose Nissen, you are choosing products that meet the highest quality standards and the strictest guidelines. This is clear from the following:



### BAST

Products with this seal have been tested by the Federal Highway Research Institute (BAST) on behalf of the Federal Ministry of Transport and Digital Infrastructure. This guarantees the highest standards of conformity.



### TL (RSA) approved

The Technical Delivery Conditions (TL) contain all the requirements for design and passive safety, which are defined in Germany in accordance with the guidelines for securing work sites on roads (RSA).



### EN 12352

This European Standard defines the requirements for the optical performance, structural design and operating characteristics of electrical lighting fixtures. Nearly all of our products in this category are developed and classified according to this standard.



### Tested quality

This seal is awarded to our products, which are developed in accordance with existing standards and which meet high technical standards. In addition to our internal audits, these products must also be audited by experts with a separate test number.

## A shining example of quality and function

Nissen lighting systems are suitable for a wide range of applications and are characterized by innovative features and reliable quality. All lights correspond to the classes defined by the RSA and/or European standards.

D	Class	Light outlet surface in cm <sup>2</sup>	Opening angle		Luminosity		
			Horizontal	Vertical	Min. in cd	Max. in cd	
	L1	(see EN 12352, 4.1.2)	300°	+5° to -5°	1	100	
	L2L	> 18	+7° to -7°	+7° to -7°	25	100	
	L2H	> 18	+7° to -7°	+7° to -7°	150	1,500	
	L3	> 75	+10° to -10°	+5° to -5°	2	100	
	L4 (F2)	> 140	+10° to -10°	+5° to -5°	43	100	
	L5	> 140	+2° to -2°	+2° to -2°	500	2,000	
	WL2	L6	> 2 x 250	+10° to -10°	+5° to -5°	10	100
	WL1	L7	> 250	+10° to -10°	+5° to -5°	20	100
	WL3	L8G	> 250	+7,5° to -7,5°	+5° to -5°	25	100
	WL4	L8L	> 250	+7,5° to -7,5°	+5° to -5°	250	500
	WL6	L8M	> 250	+7,5° to -7,5°	+5° to -5°	500	1,500
	WL6	L8H	> 250	+7,5° to -7,5°	+5° to -5°	1,500	5,000
	WL7	L9L	> 700	+1,5° to -1,5°	+1,5° to -1,5°	500	2,000
	WL5	L9M	> 700	+1,5° to -1,5°	+1,5° to -1,5°	2,000	8,000
	WL7	L9H	> 700	+1,5° to -1,5°	+1,5° to -1,5°	20,000	40,000

## You can recognize our quality right away

For our transport facilities, we use RAL-certified and retroreflective foils from well-known manufacturers. These ensure optimum recognition, even in the dark. These foils differ when it comes to the following properties:

**Type A (RA 1)**  
Microglass beads incorporated into the carrier material yield a flat reflector foil without a honeycomb structure.

**Type B (RA 2)**  
Microglass beads are encapsulated between the carrier material and the transparent cover material for an optically recognizable honeycomb structure.

**Type C (RA 3)**  
Microprisms embossed into the carrier material emit the light like a retro-reflector and are supported by a honeycomb structure.

Retroreflection	
Typ A (RA 1)	min. 60 cd lx <sup>1</sup> m <sup>2</sup>
Typ B (RA 2)	min. 180 cd lx <sup>1</sup> m <sup>2</sup>
Typ C (RA 3)	min. 300 cd lx <sup>1</sup> m <sup>2</sup>

# SERVICE IS OUR ADVANTAGE

We can customise many of the details of our products to suit your unique requirements. From the different colours to the embossing of your company logo. The following symbols show you what we can customise for you.



**PRODUCT COLOUR**  
Select your desired colour.



**FOIL**  
On request, we can print our different foils in one colour.



**LABELLING**  
Have your article fitted with a custom label.



**EMBOSSING**  
Ideal for the logo of your company, etc.



Do you have additional customisation needs?  
Contact us: [export@nissen-germany.com](mailto:export@nissen-germany.com)

## Our know-how is just a click away

Find out more about our complete product range, from safety beacons and lamps to complex systems for traffic management. Our website also offers you detailed information on many products, including detailed views, instructions, application videos, and regulations. To find this information, enter the respective **product code in the search field** to get to the desired product: [nissen-germany.com](http://nissen-germany.com)



Further information:  
**NIS-01393**  
[nissen-germany.com](http://nissen-germany.com)

# SALES GERMANY

You can find the detailed contact information for our staff in the individual sales regions at: [nissan-germany.com/vertrieb](https://nissan-germany.com/vertrieb)

HEADQUARTERS

SALES NORTH/EAST

SALES MIDDLE/WEST

SALES EAST (AND BERLIN)

SALES CENTRE/WEST

SALES NORTHERN BAVARIA

SALES SOUTH/WEST

SALES SOUTHERN BAVARIA

## SALES MANAGEMENT



**Rainer Götsche**  
Sales Director Germany

## SALES



**Nancy Töpfer**  
Regional Sales Director North/East



**Bernd Struve**  
Regional Sales Director Centre/West



**Ronny Günther**  
Regional Sales Director East



**Reinhard Feller**  
Regional Sales Director East (and Berlin)



**Michael Henseler**  
Regional Sales Director Centre/South



**Alexander Seelig**  
Regional Sales Director South/West



**Patrick Stern**  
Regional Sales Director Northern Bavaria



**Alexander Klein**  
Regional Sales Director Southern Bavaria

## CUSTOMER SERVICE



**Manuela Rotert**  
Customer Consultant North/East, East  
T +49 4861 612-212  
F +49 4861 612-144  
verkauf@nissan-germany.com



**Petra Katryniak**  
Customer Consultant Centre/West  
T +49 4861 612-111  
F +49 4861 612-144  
verkauf@nissan-germany.com



**Vanessa Perna**  
Customer Consultant South/West, Bavaria  
T +49 4861 612-156  
F +49 4861 612-144  
verkauf@nissan-germany.com



**Silke Langholdt**  
Customer Consultant  
T +49 4861 612-119  
F +49 4861 612-144  
verkauf@nissan-germany.com



**Daniel Schröder**  
Customer Consultant Quotes/Tenders  
T +49 4861 612-115  
F +49 4861 612-144  
angebote@nissan-germany.com



**Sinja Pauls**  
Customer Consultant Quotes/Tenders  
T +49 4861 612-141  
F +49 4861 612-144  
angebote@nissan-germany.com



**Marvin Ciesielski**  
Customer Consultant Quotes/Tenders  
T +49 4861 612-116  
F +49 4861 612-144  
angebote@nissan-germany.com



# INTERNATIONAL SALES

You can find the detailed contact information for our staff in the individual sales regions at: [nissan-germany.com/vertrieb](https://nissan-germany.com/vertrieb)

## EXPORT MANAGEMENT



**Sascha Düspohl**  
Export Director



**Christian Lohse**  
Export Director



## CUSTOMER SERVICE



**Doris Kratzenberg**  
Customer Consultant Export  
T +49 4861 612-158  
F +49 4861 612-169  
[export@nissan-germany.com](mailto:export@nissan-germany.com)



**Maike Bieber**  
Customer Consultant Export  
T +49 4861 612-135  
F +49 4861 612-169  
[export@nissan-germany.com](mailto:export@nissan-germany.com)

## NISSEN GROUP



**David Kakowski**  
Nissan Poland



**Jean-Marc Sciboz**  
Nissan Switzerland



**Ilyas Sharif**  
Nissan UK



**Ibon González de Audicana**  
Nissan Ibérica



**Stefan De Craecker**  
Nissan Benelux





# TRAFFIC MANAGEMENT PRODUCTS

## Secure is not enough for us

No roadwork without barriers – Nissen offers you the entire product range, from safety beacons to safety barriers. All products come from our own production facilities and are subject to the strictest quality controls. Because secure is not enough for us.

# Safety Beacons



# Safety Beacon

- Equipable with all common foil types on one or both sides
- Foil protected by surrounding edge
- Replaceable aluminium stand tube 40 x 40 mm
- Stackable without risk of slipping
- For use with beacon lamps BaKoLight LED and Konstant-Norm-LED



**Dimensions (LxWxH)**  
1319 x 304 x 60 mm



**Weight**  
3,6 kg

## Safety Beacon

### Ref. No.

Safety Beacon, one-sided, foil RA1 A, pointing left without base plate	071 322-202
Safety Beacon, one-sided, foil RA1 A, pointing right without base plate	071 324-202
Safety Beacon, one-sided, foil RA1 A, pointing left without base plate	071 330-202
Safety Beacon, two-sided, foil RA1 A, pointing left/right without base plate	071 322-22
Safety Beacon, two-sided, foil RA1 A, pointing left/right without base plate	071 324-22
Safety Beacon, one-sided, foil RA2 C, pointing left without base plate	071 330-22
Safety Beacon, one-sided, foil RA2 C, pointing right without base plate	070 293-1
Safety Beacon, two-sided, foil RA2 C, pointing left/right without base plate	
Base plate TL 56 K1	

## Accessories and Spare parts

### Ref. No.

Transport and storage rack for 60 to 72 beacons, depending on beacon type	081 600
Spare tube with stopper	071 319-2



Safety beacon system



Aluminium stand tube



Transport and storage rack



**Packaging unit**  
60 pcs on one pallet  
also available in other quantities



**More information**  
NIS-00224  
To be entered on nissen-germany.com

**Test number**  
94 2K 013 2000 2K 01

# Reversible Beacon WeBaNi 40

- Equipable with all common foil types on one or both sides
- Foil protected by surrounding edge
- 180° reversible, two arrow directions
- Replaceable full-length aluminum stand tube, with 2 connecting pieces, 40 x 40 mm
- Easy fixing of warning lamps BaKoLight LED and Konstant-Norm-LED
- Non-slip stackable



**Dimensions (LxWxH)**  
1400 x 300 x 54 mm



**Weight**  
2,4 kg

## Reversible Beacon WeBaNi 40

### Ref. No.

WeBaNi 40, one-sided, foil RA2 C, arrow red/white without base plate	070 321-2
Base plate TL 56 K1	070 293-1

## Accessories and Spare parts

### Ref. No.

Transport and storage rack for 60 to 72 beacons, depending on beacon type	081 600
---	---------



Safety beacon system



Stacked beacons



Transport and storage rack



**Packaging unit**  
60 pcs on one pallet  
also available in other quantities



**More information**  
NIS-00287  
To be entered on nissen-germany.com

**Test number**  
V4-12/2006

# Standard Beacon

- Equipable with all common foil types on one or both sides
- Foil protected by surrounding edge
- No internal steel tube, therefore recycling without separation of material
- 1 plastic connecting piece, 60 x 60 mm
- Non-slip stackable
- Easy fixing of warning lamps resp. beacon lamps



**Dimensions (LxWxH)**  
1335 x 287 x 60 mm



**Weight**  
2,6 kg

## Standard Beacon

## Ref. No.

Beacon, basic colour white, two-sided, foil RA1 A, pointing left/right without base plate	070 236-204
Beacon, basic colour white, two-sided, foil RA2 C, pointing left/right without base plate	070 236-224
Base plate K1	070 350-31
base plate Light	070 350-33
Base Plate Kompakt K1	070 350-80

## Accessories and Spare parts

## Ref. No.

Transport and storage rack for 60 to 72 beacons, depending on beacon type	081 600
---	---------



Universal base plate K1



Transport and storage rack



**Packaging unit**  
60 pcs on one pallet  
also available in other quantities



**More information**  
NIS-00237  
To be entered on nissen-germany.com

# Reversible Beacon WeBaNi 60

- Equipable with all common foil types on one or both sides
- Foil protected against damage by protective rim
- 180° reversible, two arrow directions
- Recyclable without separation of materials
- 2 connecting pieces, 60 x 60 mm
- Non-slip stackable



**Dimensions (LxWxH)**  
1415 x 287 x 60 mm



**Weight**  
2,6 kg

## Reversible Beacon WeBaNi 60

## Ref. No.

WeBaNi 60, one-sided, foil RA2 C, arrow red/white, without base plate	070 331-2
WeBaNi 60, two-sided, foil RA2 C, arrow red/white pointing left/right, without base plate	070 332-2
Beacon WeBaNi 60, two-sided, foil RA2 C, arrow red/white pointing right/right, without base plate	070 333-2
Base plate K1	070 350-31
base plate Light	070 350-33
Base Plate Kompakt K1	070 350-80

## Accessories and Spare parts

## Ref. No.

Transport and storage rack for 60 to 72 beacons, depending on beacon type	081 600
---	---------



transport and storage rack



Base plate K1



**Packaging unit**  
60 pcs on one pallet  
also available in other quantities



**More information**  
NIS-00291  
To be entered on nissen-germany.com

# Plastic safety barriers

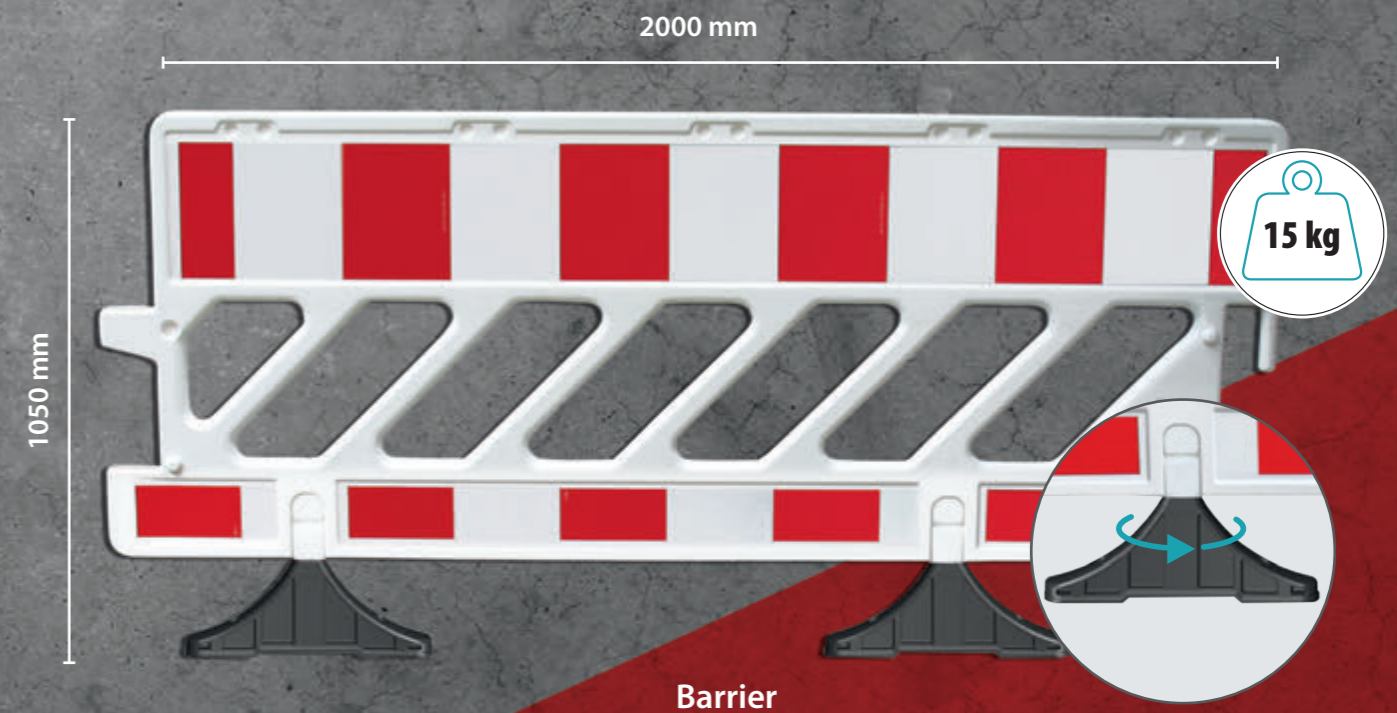
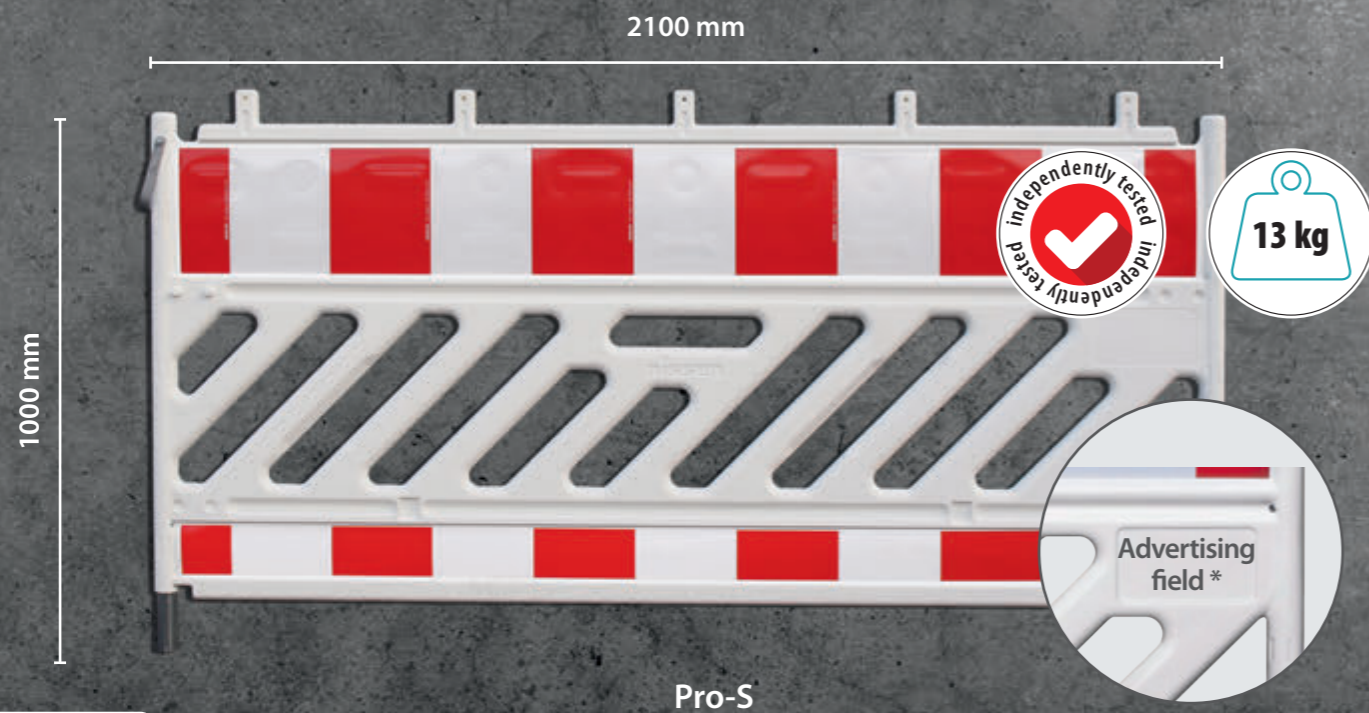
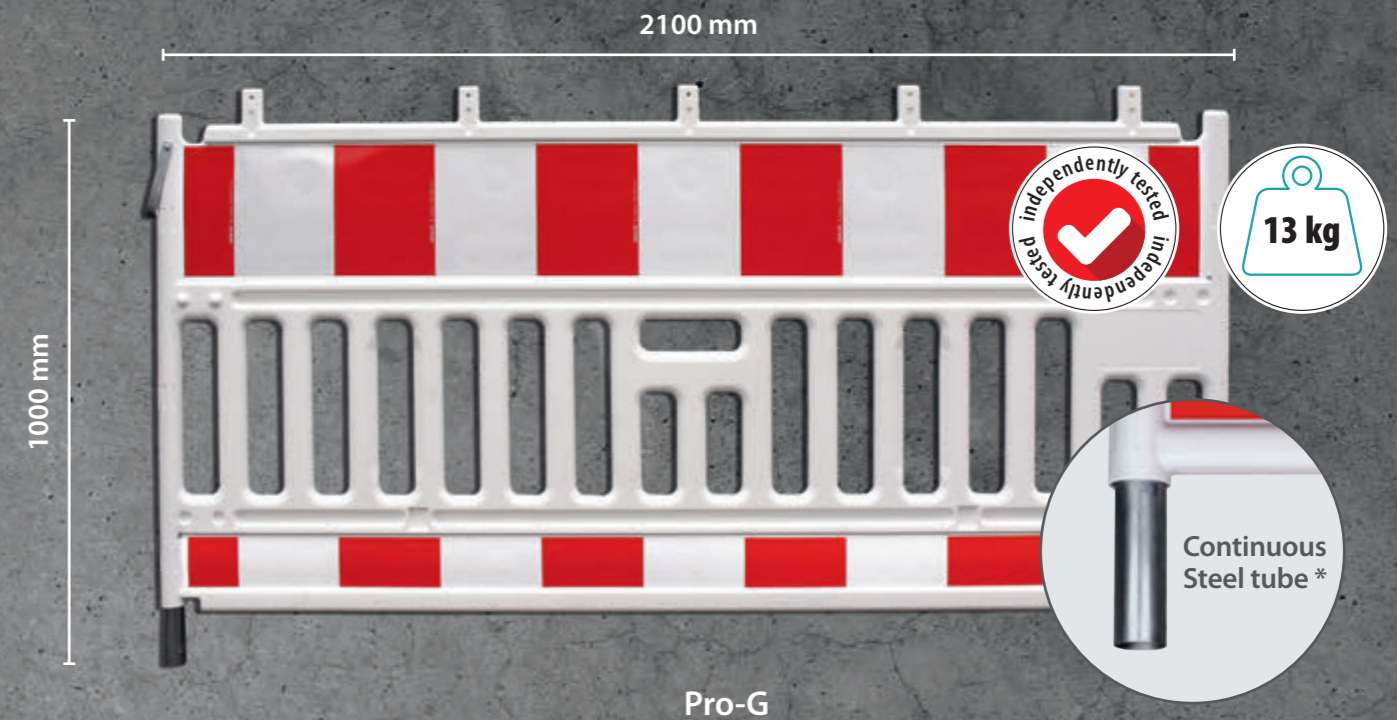
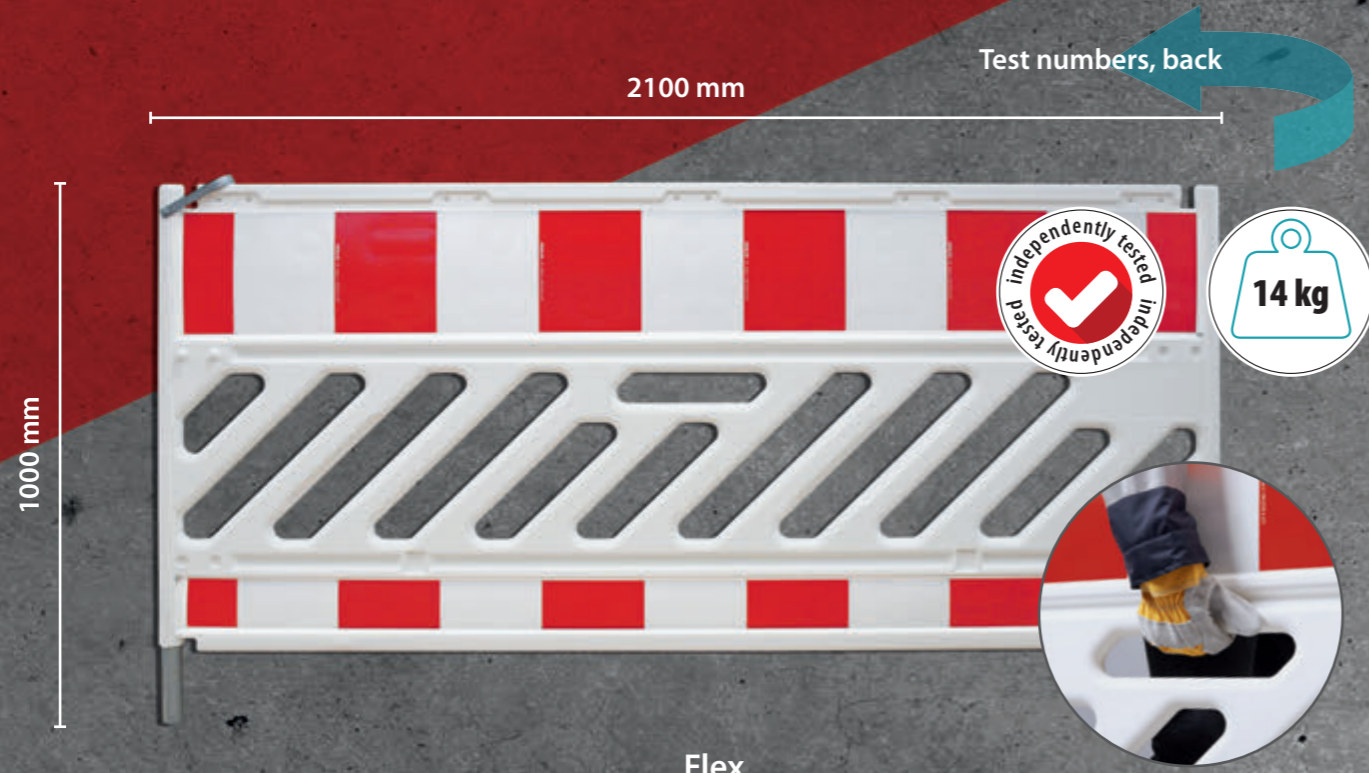

\* Applies to all safety barriers

# Mobile Plastic Safety Barrier Pro-S

- Made of high quality plastic
- Barrier and blind man's rail equipable with all common foil types on one side
- Area for company logo or advertisement, 200 x 110 mm (WxH)
- Useful carrying handle
- Stacking lugs for safe storage and transportation
- According to German Standards



**Dimensions (WxH)**  
2100 x 1000 mm



**Weight**  
13 kg

## Mobile Plastic Safety Barrier Pro-S

**Ref. No.**

- Mobile Plastic Safety Barrier Pro-S, one-sided foil type RA1 A red/white
- Mobile Plastic Safety Barrier Pro-S, one-sided foil type RA2 B red/white
- Mobile Plastic Safety Barrier Pro-S, one-sided foil type RA1 A red/gelb

- 071 658-01
- 071 658-02
- 071 658-06



Safety barrier in base plate



Individual advertising area



Reflector



BakoLight on safety barrier



**Packaging unit**  
5 pcs in one bunch  
also available in other quantities



**More information**  
NIS-01727  
To be entered on nissen-germany.com

# Mobile Plastic Safety Barrier Pro-G

- Made of high quality plastic
- Barrier and blind man's rail equipable with all common foil types on one side
- Area for company logo or advertisement, 200 x 110 mm (WxH)
- Useful carrying handle
- Stacking lugs for safe storage and transportation
- According to German Standards

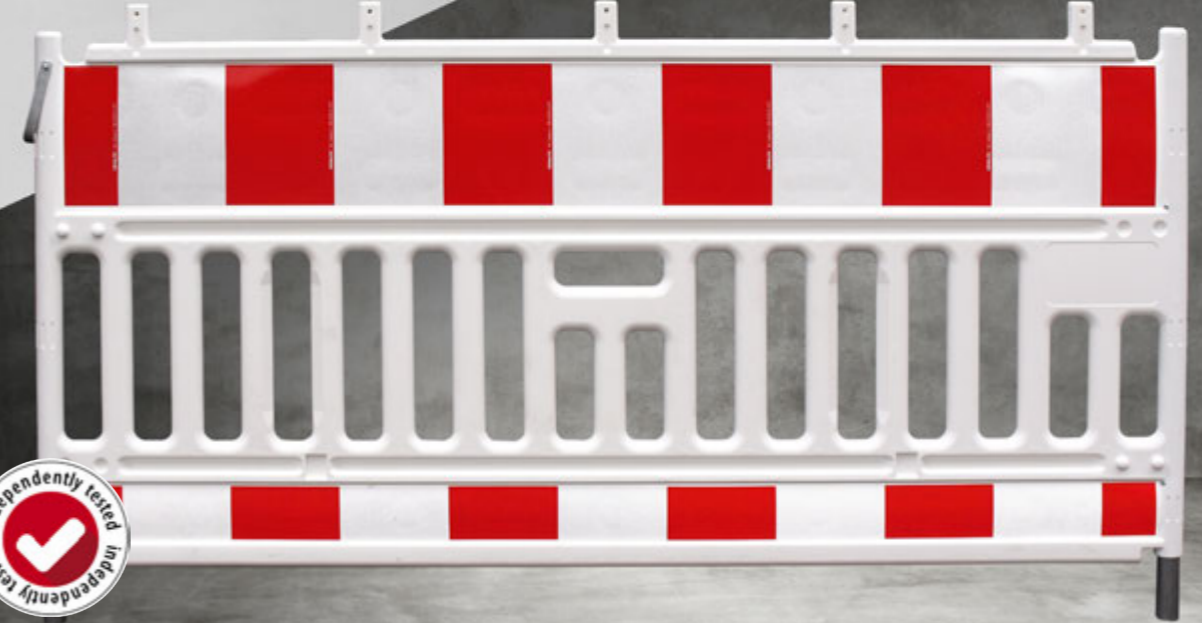

**Dimensions (WxH)**  
2100 x 1000 mm



**Weight**  
13 kg

## Mobile Plastic Safety Barrier Pro-G

**Ref. No.**

- Mobile Plastic Safety Barrier Pro-G, one-sided foil type RA1 A red/white
- Mobile Plastic Safety Barrier Pro-G, one-sided foil type RA2 B red/white
- Mobile Plastic Safety Barrier Pro-G, one-sided foil type RA1 A red/yellow

- 071 659-01
- 071 659-02
- 071 659-06



Plastic barrier in base plate



Individual advertising area



Reflector



Reflection foil on strut



**Packaging unit**  
5 pcs in one bunch  
also available in other quantities



**More information**  
NIS-01724  
To be entered on nissen-germany.com

# Mobile Plastic Safety Barrier Flex

- Made of high quality plastic
- Barrier and blind man's rail equipable with all common foil types on one side
- With connecting holes for mounting warning lamps
- Optional with lamp pin
- Area for company logo or advertisement, 200 x 110 mm (WxH)
- Stacking lugs for safe storage and transportation
- According to German Standards



**Dimensions (WxH)**  
2100 x 1000 mm



**Weight**  
14 kg

## Mobile Plastic Safety Barrier Flex

**Ref. No.**

Mobile Plastic Safety Barrier Flex, one-sided foil RA1 A rot/weiß	071 657-01
Mobile Plastic Safety Barrier Flex, one-sided foil RA2 B rot/weiß	071 657-02
Mobile Plastic Safety Barrier Flex, one-sided foil RA1 A red/yellow	071 657-06

## Accessories and Spare parts

**Ref. No.**

Lamp pin white for safety barrier Flex	292 210-004
--	-------------



Plastic Safety Barrier Flex



Warning lamp on safety barrier



Individual advertising area

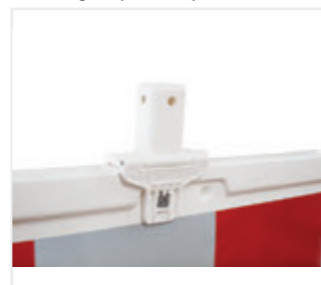

Lamp pin for retrofitting



**Packaging unit**  
5 pcs in one bunch  
also available in other quantities



**More information**  
NIS-01322  
To be entered on nissen-germany.com

# Mobile Plastic Barrier

- Suitable for events to separate and guide visitors and participants
- Simple but stable set-up with integrated connecting system
- Barrier and blind man's rail equipable with all common foil types on one side
- Foil protected against damage by frame recess
- Area for company logo or advertisement, 144 x 84 mm (WxH)
- Swivelling bases, locking system patented
- Universally stackable



**Dimensions (WxH)**  
2000 x 1050 mm



**Weight**  
15 kg

## Mobile Plastic Barrier

**Ref. No.**

Mobile Plastic Barriers, one-sided, foil red/white, RA1 A	071 680-1
Mobile Plastic Barriers, one-sided, foil red/white, RA2 B	071 680-21

## Accessories and Spare parts

**Ref. No.**

Transport and storage rack for 20 Mobile Light Plastic Barriers	071 685-1
---	-----------



Transport and storage rack



Swivelling bases



Individual advertising area



**Packaging unit**  
5 pcs in one bunch  
also available in other quantities



**More information**  
NIS-00244  
To be entered on nissen-germany.com

# Accessories for Safety Barriers

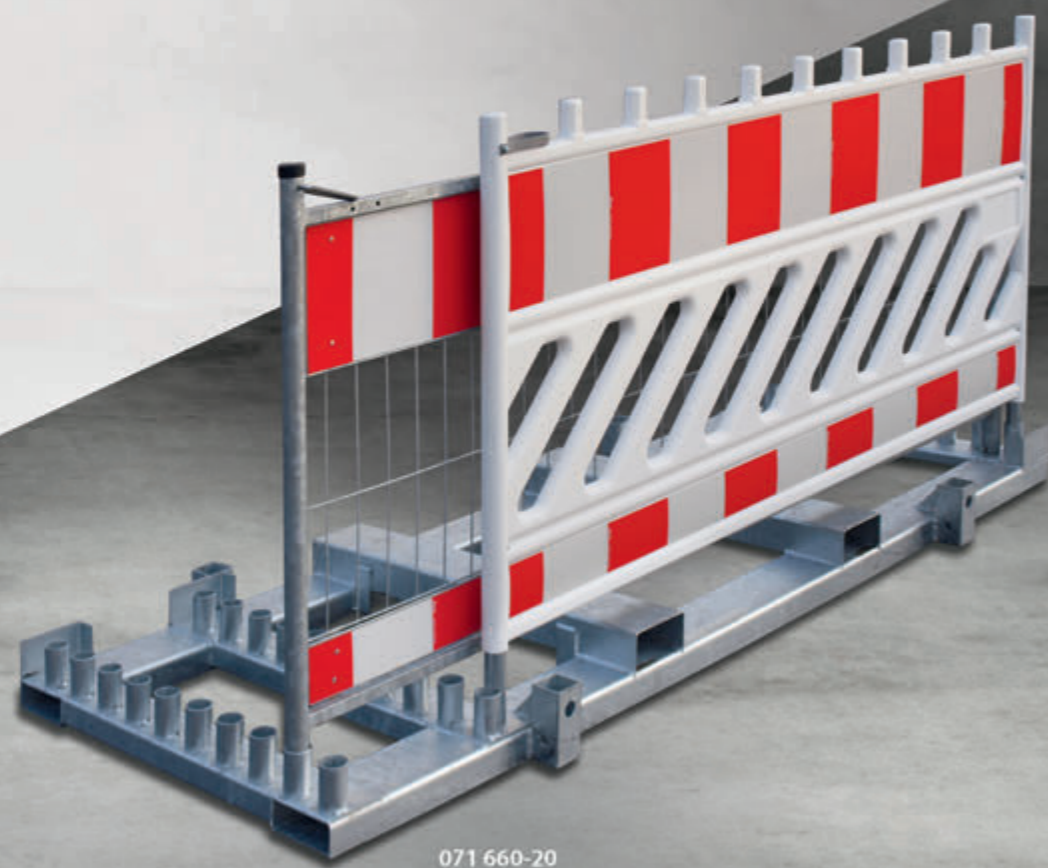

071 660-20

## Accessories for Safety Barriers

	Ref. No.
Transport and storage rack Simplex for 20 safety barriers 2000 mm or 2400 mm (stackable)	071 660-31
Transport and storage rack for 20 safety barriers 2000 mm, (stackable) Other versions on request	071 660-3
Transport and storage rack, Standard for 20 safety barriers 2000 mm, not stackable Other versions on request	071 660-3-1
Transport and storage rack Kombi for 20 safety barriers 2000 mm or 2400 mm (stackable)	071 660-20
Pile support for Kombi-/Standard version (1 pc)	071 660-21
1 set of pile supports, consisting of 4 pcs	071 660-24



Storage racks with safety barriers



# Base plates



Base plate TL 56 K1

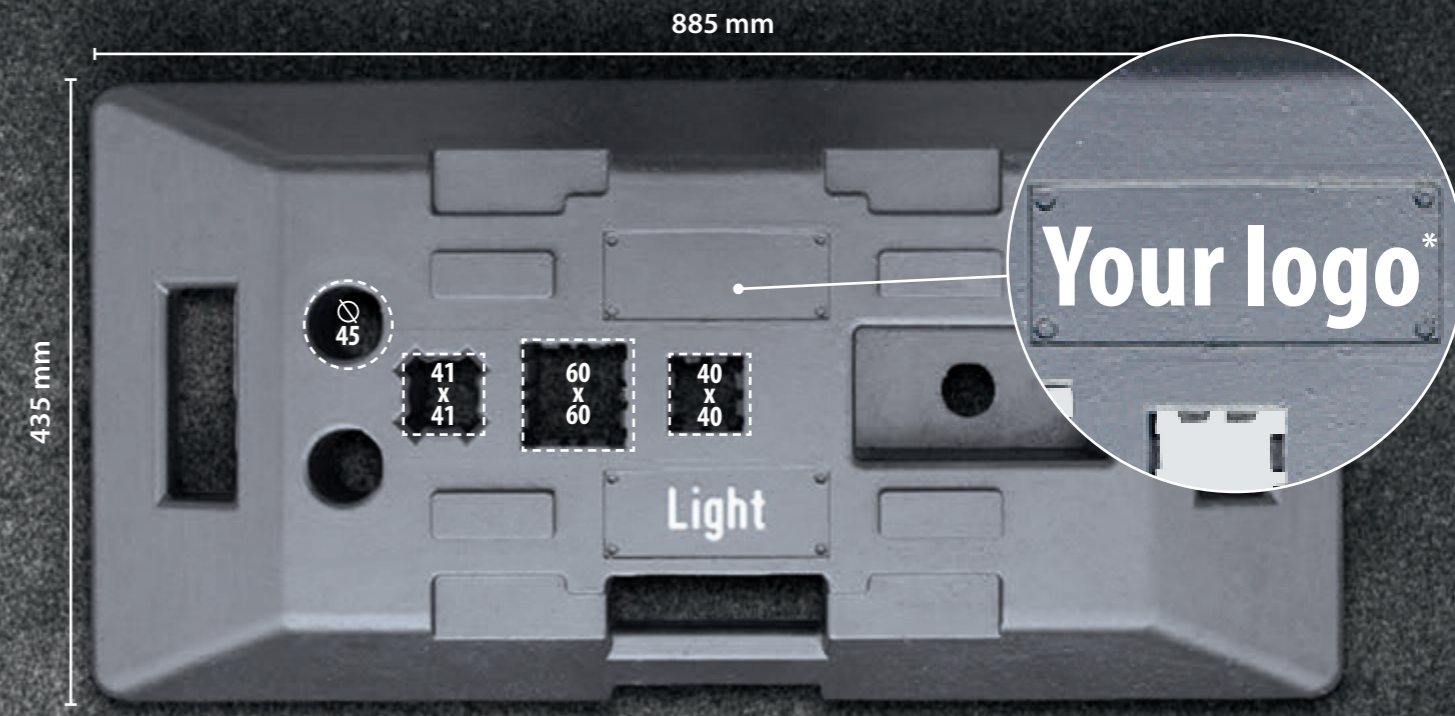

Base plate light

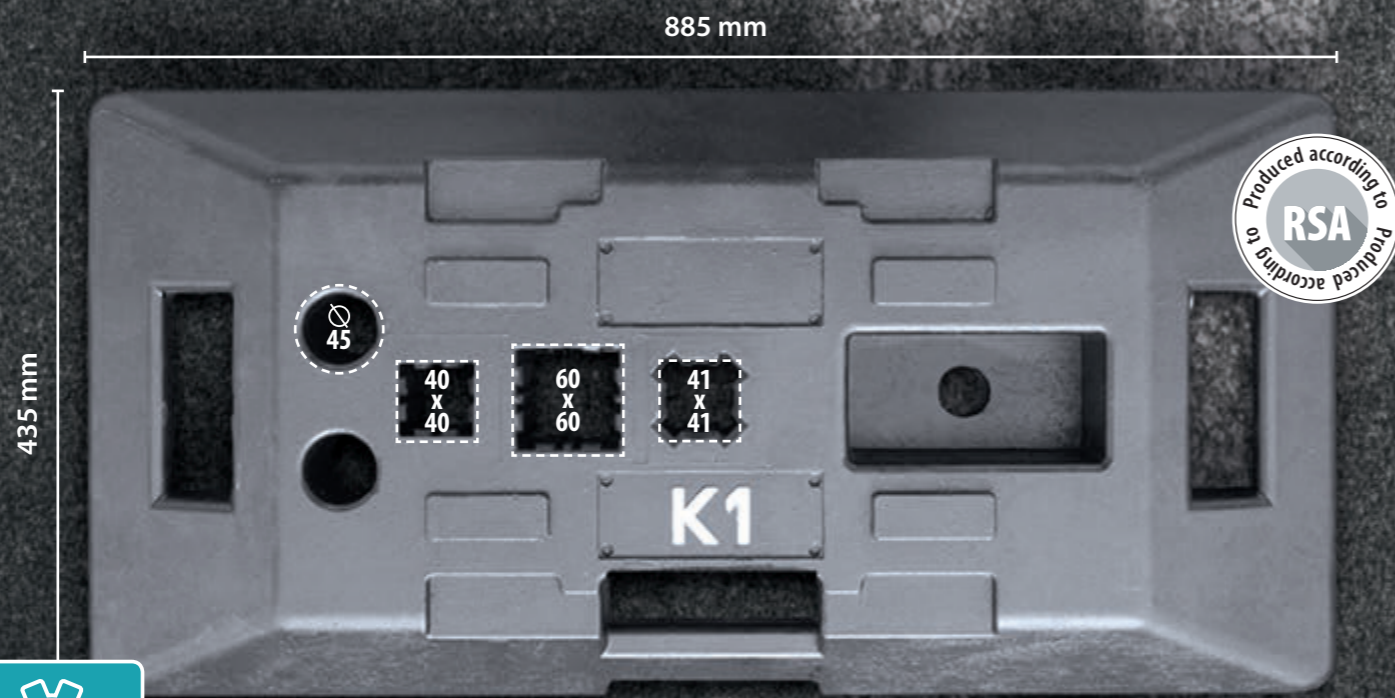

Base plate K1

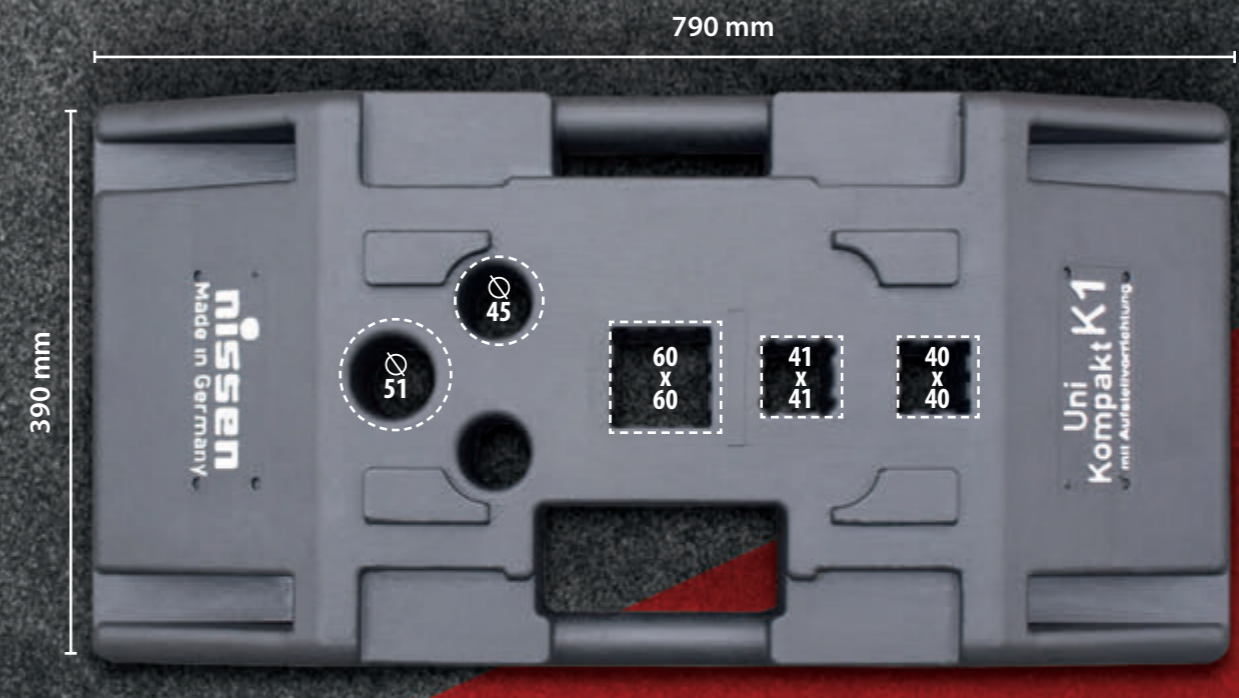

Base plate Kompakt K1



\* Applies to all base plates  
Dimensions in mm

# Base Plate TL 56 K1

- Made of recycled material in an injection moulding process



**Dimensions (LxWxH)**  
895 x 440 x 115 mm



**Weight**  
28,5 kg



**Hole**  
40x40, 41x41 / Ø 43, 60x60,  
2 x Ø 45, battery compartment

**Base Plate TL 56 K1**

**Ref. No.**

Base plate TL 56 K1

070 293-1



Safety beacon system



**Packaging unit**  
30 pcs on one pallet  
also available in other quantities



**More information**  
NIS-00606  
To be entered on nissen-germany.com

# Base Plate K1

- Made of recycled material in an injection moulding process
- Application depending on country-specific regulations

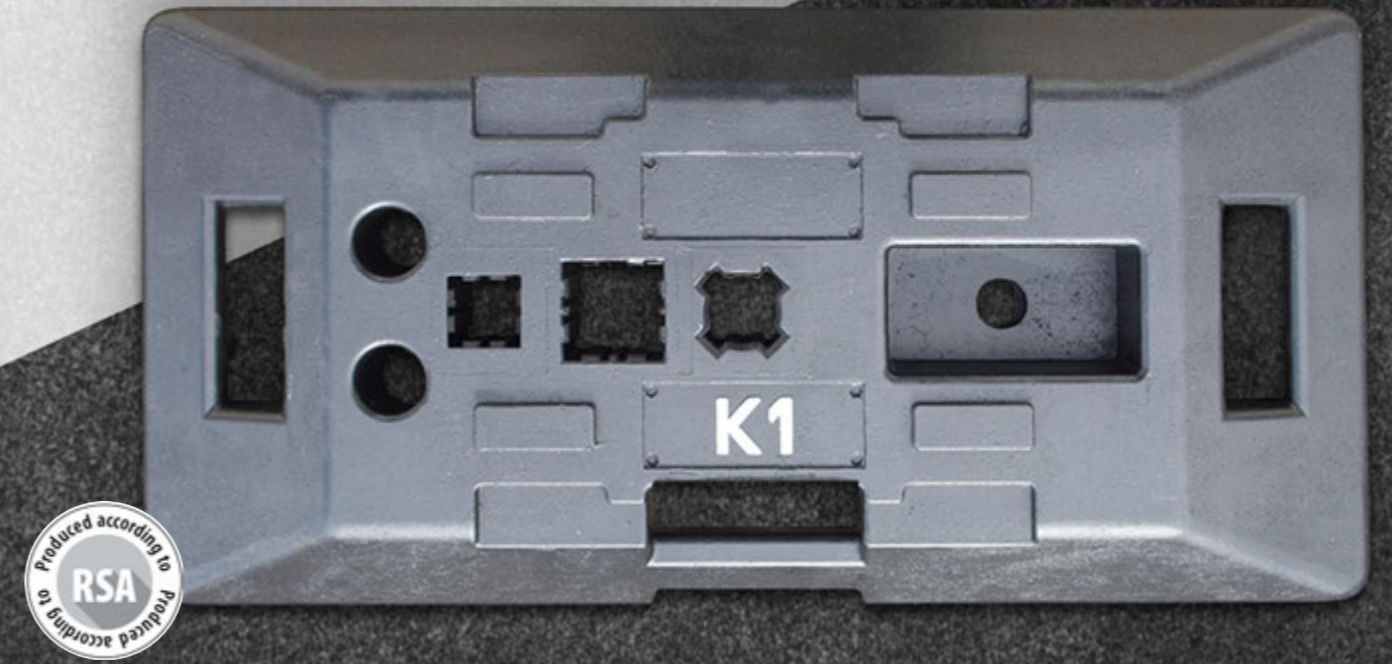

**Dimensions (LxWxH)**  
885 x 435 x 120 mm



**Weight**  
28,5 kg



**Hole**  
40x40, 41x41 / Ø 43, 60x60,  
2 x Ø 45, battery compartment

**Base Plate K1**

**Ref. No.**

Base plate K1

070 350-31



Standard Beacon in base plate K1



**Packaging unit**  
36 pcs on one pallet  
also available in other quantities



**More information**  
NIS-00608  
To be entered on nissen-germany.com

# Base Plate Light

- Made of recycled material in an injection moulding process
- Application depending on country-specific regulations
- Less than 25 kg load capacity

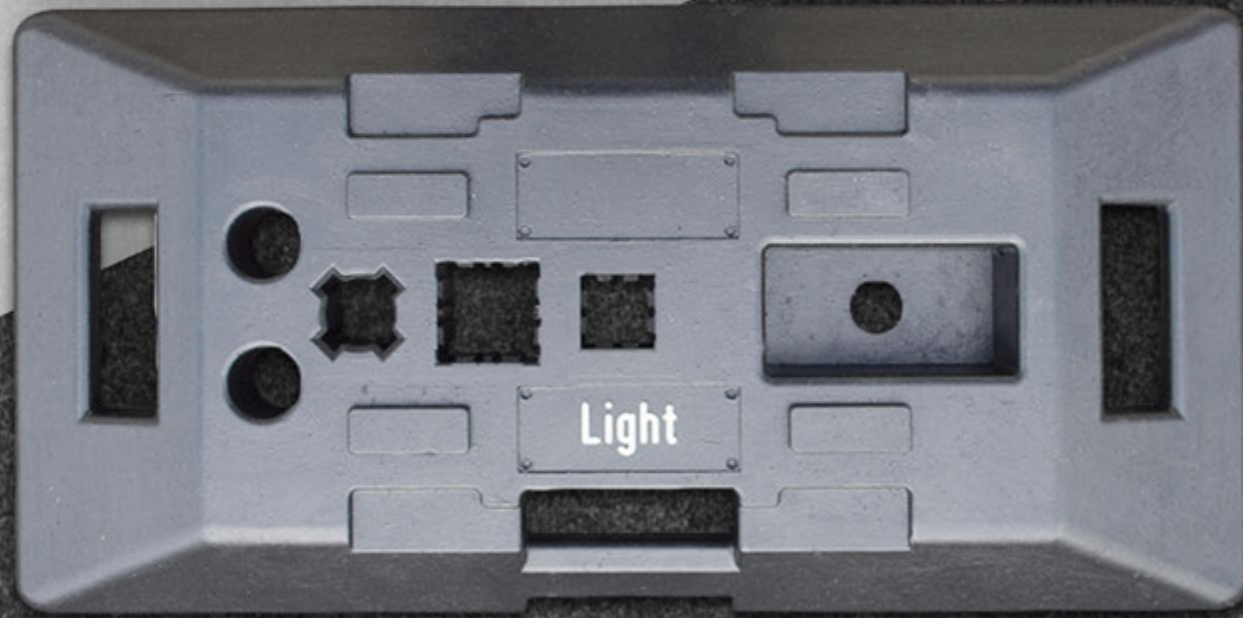

**Dimensions (LxWxH)**  
885 x 435 x 104 mm



**Weight**  
24 kg



**Hole**  
40x40, 41x41 / Ø 43, 60x60,  
2 x Ø 45, battery compartment

# Base Plate Kompakt K1

- Made of recycled material in an injection moulding process

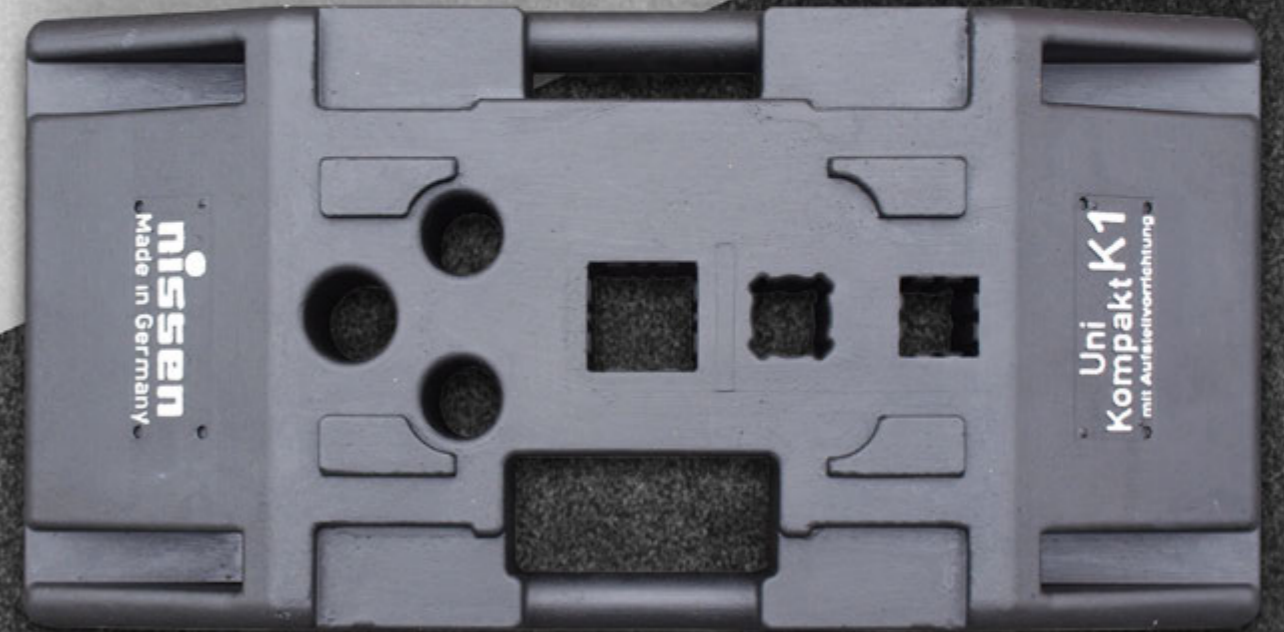

**Dimensions (LxWxH)**  
790 x 390 x 130 mm



**Weight**  
28 kg



**Hole**  
40x40, 41x41, Ø43, 2xØ45, Ø51  
60x60, battery compartment

**Base Plate Light**

**Ref. No.**

base plate Light

070 350-33



**Base Plate Kompakt K1**

**Ref. No.**

Base Plate Kompakt K1

070 350-80



**Packaging unit**  
36 pcs on one pallet  
also available in other quantities



**More information**  
NIS-00609  
To be entered on nissen-germany.com



**Packaging unit**  
30 pcs on one pallet  
also available in other quantities



**More information**  
NIS-00610  
To be entered on nissen-germany.com

# Guidance system



Tornado 75



Small beacon (Indicator)



Base plate Tornado 75



Quick marker

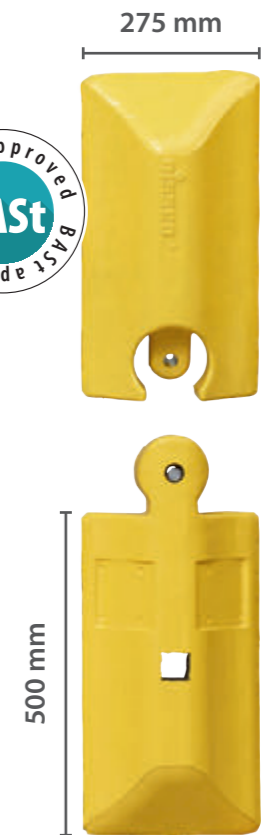

Quick marker start and end components

# Quick Marker

- Strong road grip by skid-resistant base-studs, no collection of water
- To be removed from the road surface without traces
- Openings for reflector elements, indicators and beacon Tornado 75-Flex
- Practical assembly tool available
- Curve laying possible
- Environment friendly, made of recycled material



# Small Beacon (Indicator)

- Beacon reduced by 50 % according to German Standards
- Compatible with traffic guidance system Quick Marker
- Equipable with all common foil types on one or both sides
- Reflecting area 125 x 500 mm
- Can be run over several times without danger



**Material**  
recycled plastic material

**Dimensions (LxWxH)**  
Quick Marker  
1000 x 275 x 95 mm

**Dimensions (LxWxH)**  
initial/end piece  
500 x 275 x 95 mm

**Weight**  
Quick Marker 19 kg,  
initial/end piece 9 kg

**Material**  
plastic

**Colour**  
black

**Dimensions (HxWxD)**  
660 x 130 x 32,6 mm

**Weight**  
0,32 kg

**Quick Marker** **Ref. No.**

Quick Marker Type B, yellow, with 2 reflector elements	070 665-541
Quick Marker start piece with recess, yellow	070 660-4
Quick Marker end piece with nose, yellow	070 662-4

**Accessories and Spare parts** **Ref. No.**

Reflector elements, yellow (2 pcs each Quick Marker needed)	070 642-4
Hexagon head screw M12 x 80, hot-galvanized	010 283
Battery impact wrench with rapid charger for bolting	070 652
Quick Marker elements	070 373
Box spanner insert for bolting Quick Marker elements	070 653-2
Assembly tool for Quick Marker	070 377
Unlocking tool for Indicator	



Traffic Guidance System Quick Marker



Quick Marker with Tornado 75-Flex



Assembly tool

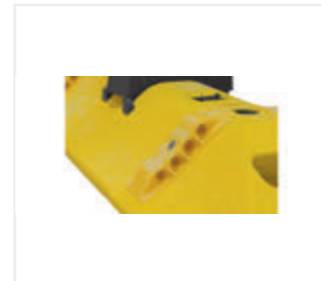

Reflector element

**Small Beacon (Indicator)** **Ref. No.**

Indicator, one-sided, foil RA2 B pointing left	071 255-21
Indicator, two-sided, foil RA2 B pointing left	071 250-21
Indicator, one-sided, foil RA2 B pointing right	071 265-21
Indicator, two-sided, foil RA2 B pointing right	071 260-21
Indicator, two-sided, foil RA2 B pointing right/left	071 270-21

**Accessories and Spare parts** **Ref. No.**

Transport and storage rack for up to 150 small beacons	081 608-1
--	-----------



Small Beacon (Indicator)



Small Beacon on a Quick Marker

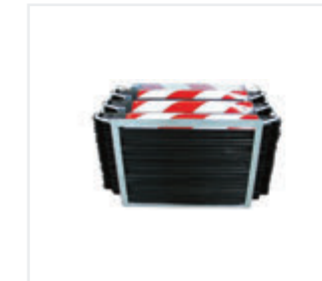

Transport and storage rack

**Packaging unit**  
56 pcs on one pallet / weight: 1064 kg  
also available in other quantities

**More information**  
NIS-00248  
To be entered on nissen-germany.com

**Test number**  
V4-17/2006

**Packaging unit**  
25 pcs in one carton  
also available in other quantities

**More information**  
NIS-00259  
To be entered on nissen-germany.com

# Tornado 75-Flex

- For use in Quick Marker or with separate base plate
- Equipped with reflecting foil RA2 C on one or both sides
- Reflective area 187,5 x 750 mm
- Foil protected by surrounding edge
- Can be run over without danger



**Dimensions (LxWxH)**  
930 x 202 x 110 mm



**Weight**  
1,2 kg

# Base Plate for Tornado 75-Flex

- For quick setting of Tornado 75-Flex
- With additional hole for beacons, 40 x 40 mm and four reflecting elements
- Standard colour yellow, other colours possible
- Made of recycled plastic



**Dimensions (LxWxH)**  
900 x 275 x 92 mm



**Hole**  
40 x 40 mm



**Weight**  
14 kg

## Tornado 75-Flex

### Ref. No.

Tornado 75-Flex, without foil, without base plate	071 540-1
Tornado 75-Flex, one-sided, foil RA2 C pointing left, without base plate	071 541-2
Tornado 75-Flex, one-sided, foil RA2 C pointing right, without base plate	071 542-2
Tornado 75-Flex, two-sided, foil RA2 C pointing left/right without base plate	071 543-2

## Accessories and Spare parts

### Ref. No.

Base plate, yellow, for Tornado 75-Flex, ca. 14 kg	071 292-4
Base plate, yellow, for Tornado 75-Flex, ca. 14 kg with 4 reflector elements	071 292-14



Tornado 75-Flex pointing left and right



Tornado 75-Flex with base plate



Tornado 75-Flex with Quick Marker

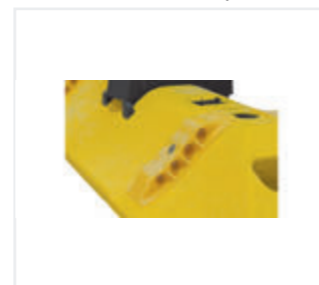

Reflector element

## Base Plate for Tornado 75-Flex

### Ref. No.

Base plate Tornado 75-Flex, yellow	071 292-4
Base plate Tornado 75-Flex, yellow with four reflecting elements	071 292-14



Base plate with four reflecting elements



Base plate with Tornado 75-Flex



**Packaging unit**  
5 pcs in one carton  
also available in other quantities



**More information**  
NIS-00271  
To be entered on nissen-germany.com

**Test number**  
V4-16/2006



**More information**  
NIS-00860  
To be entered on nissen-germany.com

# Folding NiColl<sup>75</sup>



# Folding Beacon NiColl<sup>75</sup>

- Equipable with all common foil types on one or both sides
- High level of stability
- Easy handling through the optimum positioning of carrying handles on the baseplate
- Stackable with locking aid
- Maintenance-free, durable and with a robust folding hinge
- Beacon plate and folding hinge easily replaceable
- Rollover protection for the beacon plate
- Foil protection in transport position
- Compact structure



**Material**  
Folding beacon:  
high quality plastic



**Material**  
Base plate: recycled plastic



**Dimensions (HxWxD)**  
Folding beacon:  
980 x 202 x 50 mm



**Dimensions (LxWxH)**  
Base plate:  
800 x 300 x 95 mm



**Colour**  
Folding beacon and base plate:  
black



**Reflective area**  
750 x 187 mm



**Weight**  
13 kg

## Folding Beacon NiColl<sup>75</sup>

### Ref. No.

Folding beacon NiColl <sup>75</sup> , one-sided, foil RA2 C pointing left, with black base plate	071 800-201
Folding beacon NiColl <sup>75</sup> , one-sided, foil RA2 C pointing right, with black base plate	071 800-202
Folding beacon NiColl <sup>75</sup> , two-sided, foil RA2 C pointing left/right, with black base plate	071 800-203
Folding beacon NiColl <sup>75</sup> , two-sided, foil RA2 C pointing right, with black base plate	071 800-204
Folding beacon NiColl <sup>75</sup> , two-sided, foil RA2 C arrow red/white, pointing left and right, with black base plate	071 800-213

## Accessories and Spare parts

### Ref. No.

Galvanised steelt transport and storage rack, for 5 folding beacons NiColl <sup>75</sup> with base plates	071 795-01
Galvanised steelt transport and storage rack, for 30 folding beacons NiColl <sup>75</sup> with base plates	071 795-04



Stacked



Folded



Folding hinge



**Packaging unit**  
30 beacons with base plates on a pallet



**More information**  
NIS-01393  
To be entered on nissen-germany.com

**Test number**  
V4-01-2015



# TrioSign: Folding Traffic Signs

- All made from our in-house development and production
- Available for almost all areas of application and countries
- Signs and text customizable from all sides
- A wide range of well-thought-out details for easy handling
- First-class foils and steel tripods



TrioSign folding signs are available with white and yellow foil and in three different reflection classes, respectively: daytime visibility (R0), highly reflective (R1) and very highly reflective (R2). All foils are waterproof and weatherproof.



# Folding Traffic Signs

- Signal covering made of PVC coated plastic fabric
- Tripod made of galvanized steel and slipcover
- Traffic signs as required, the three sides can be fitted individually
- Further use due to exchangeable additional signs (optional)
- Nitra, Star-Flash and City Flash without additional adapter attachable
- Easy replacing of the signal covering
- Additional centre weight available for increased stability and telescope tube (optional)



## Folding Traffic Signs

- Folding Traffic Sign Type 60 with **white normal foil**, side length 600 mm
- Folding Traffic Sign Type 60 with **retroreflective foil**, side length 600 mm
- Folding Traffic Sign Type 70 with **white normal foil**, side length 700 mm
- Folding Traffic Sign Type 70 with **retroreflective foil**, side length 700 mm
- Folding Traffic Sign Type 90 with **white normal foil** side length 900 mm
- Folding Traffic Sign Type 90 with **retroreflective foil**, side length 900 mm
- Folding Traffic Sign Type 110 with **white normal foil**, side length 1100 mm
- Folding Traffic Sign Type 110 with **retroreflective foil**, side length 1100 mm

## Ref. No.

- 167 060-1
- 167 061-1
- 167 070-1
- 167 071-1
- 167 090-1
- 167 091-1
- 167 110-1
- 167 111-1



## Accessories and Spare parts

- Velcro band, fluorescent, for folding traffic sign type 70
- Velcro band, retroreflecting, for folding traffic sign type 70
- Velcro band, fluorescent, for folding traffic sign type 90
- Velcro band, retroreflecting, for folding traffic sign type 90
- Velcro band, fluorescent, for folding traffic sign type 110
- Velcro band, retroreflecting, for folding traffic sign type 110

## Ref. No.

- 266 190
- 266 191
- 266 200
- 266 201
- 266 210
- 266 211

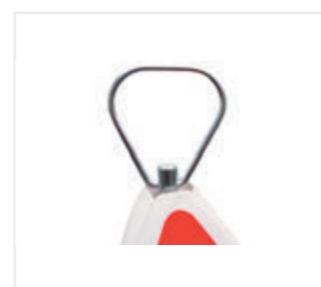

# Traffic cones



# Traffic Cones (according to German Standards)

- Heavy base plate for increased stability
- Strong road grip by skid-resistant base-studs
- No damaging of the foil because of stacking on the base plate
- Cone body made of high-impact PE material
- Base plates made of recycled material
- 750 mm cones in one-part and two-parts available



**Dimensions base plate**  
cone 500 mm:  
312 x 312 x 35 mm



**Height of stripes**  
cone 500 mm: 85 mm



**Dimensions base plate**  
cone 750 mm:  
462 x 462 x 35 mm



**Height of stripes**  
cone 750 mm: 134 mm

## Traffic Cones (according to German Standards)

	Ref. No.
Traffic Cone 500 mm, two-part, red/white, fully retroreflecting foil type A weight 2,5 kg	071 110-5
Traffic Cone 750 mm, two-part, red/white, fully retroreflecting foil type A weight 5 kg	071 120-5
Traffic Cone 500 mm, two-part, red/white, fully retroreflecting foil type B weight 2,5 kg	071 110-6
Traffic Cone 750 mm, two-part, red/white, fully retroreflecting foil type B weight 5 kg	071 120-6
Traffic Cone 750 mm, one-part, red/white, fully retroreflecting, foil type B, class II, PVC, weight 4,5 kg	071 121-6
Traffic Cone 750 mm, one-part, red/white, fully retroreflecting, foil type B, class III, PVC, weight 5,3 kg	071 122-6

## Accessories and Spare parts

	Ref. No.
Adapter for using the Nitra, Euro-Nitra, Star-Flash and City Flash on traffic cones	081 736-1
Bracket for mounting the MonoLight on traffic cones	292 032-3
Bracket for mounting the Nitra, Euro-Nitra, Star-Blitz and City Flash on traffic cones	292 032-10



Traffic cone 500 and 750 mm



Traffic Cones made of PVC 750 mm



Bracket for lamps



**Packaging unit**  
10 pcs 500 mm in one carton  
5 pcs 750 mm in one carton  
also available in other quantities



**More information**  
NIS-00426  
To be entered on nissen-germany.com

# Traffic Cones

- Easy handling because of low weight
- Strong warning effect due to broad white stripes
- Easy disposal, no separation of material necessary



## Traffic Cones

	Ref. No.
Traffic Cone 320 mm with 1 white stripes, one-part, PVC weight approx. 0,6 kg, not tested	071 125-1
Traffic Cone 500 mm with 2 white stripes, one-part, PVC weight approx. 1,2 kg, not tested	071 126-1
Traffic Cone 750 mm with 2 white reflective stripes, two-part foil RA1 A (type 1), weight 5 kg, not tested	071 120-3
Traffic Cone 1000 mm with 2 white stripes, one-part, weight 6,5 kg not tested	070 012
Traffic Cone 1000 mm with 2 retroreflecting stripes, one-part, weight 7 kg not tested	070 016

## Accessories and Spare parts

	Ref. No.
Bracket for mounting the MonoLight on traffic cones	292 032-3
Adapter for using the Nitra, Euro-Nitra, Star-Flash and City Flash on traffic cones	081 736-1
Bracket for mounting the Nitra, Euro-Nitra, Star-Blitz and City Flash on traffic cones	292 032-10



Traffic Cones made of PVC 320 + 500 mm



Traffic Cone 750 mm



Traffic Cones made of PVC 1000 mm



**Packaging unit**  
20 pcs 320 mm in one carton  
10 pcs 500 mm in one carton  
5 cones 750 mm in one carton  
also available in other quantities



**More information**  
NIS-00888  
To be entered on nissen-germany.com

# MOBILITY IS OUR MISSION



# LIGHT AND LAMPS

## We light up the darkness

From warning lamps to complex traffic systems, Nissen's active light systems are developed and produced by experts and meet the highest of quality standards. Our special lens technology with individually calculated optical surfaces ensures optimum light output. This means that each of our lights can be operated with only one energy-saving LED, which significantly reduces energy consumption and prolongs operating times. Choose our leading-edge technology and take advantage of more efficiency. Point the way with our products.

# Warning lamps



BakoLight LED

BAST approved according to "TL-Warnleuchten" WL1 WL2 1x

Konstant-Norm LED

BAST approved according to "TL-Warnleuchten" WL1 WL2 1x

Euro-Nitra LED

BAST approved according to "TL-Warnleuchten" WL1 WL2 2x

Nitra LED

Lamp class L3 according to EN12352 2x

MonoLight LED

Lamp class L3 according to EN12352 1x

# BakoLight LED

- Easy mounting on beacon systems
- Easy attachment to barriers and to tubes with the optional bracket
- Automatic solar switch and stand-by indicator
- Only one battery integrated, therefore no cable connection



**Light colour**  
amber or red



**Eff. light intensity**  
amber one-sided 30 cd /  
two-sided 12 cd



**Eff. light intensity**  
red one-sided 25 cd



**Blink-/flash rate**  
60 - 70 fl./min.



**Dimensions (LxWxH)**  
267 x 105 x 275 mm



**Weight**  
0,8 kg

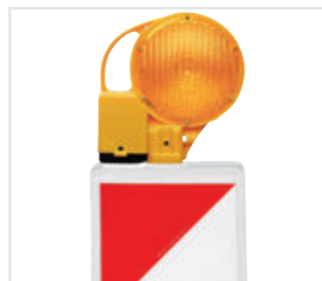

BakoLight LED on a Safety Beacon



BakoLight LED on a Safety Barrier



Key



BakoLight with bracket

BakoLight LED	Ref. No.
BakoLight LED, flashing/steady light, one-sided amber, with bracket	111 241-51
BakoLight LED, flashing/steady light, two-sided amber, with bracket	111 242-51
BakoLight LED, flashing/steady light, one-sided red, with bracket	111 241-53
BakoLight LED, flashing/steady light, one-sided amber, without bracket	111 241-1
BakoLight LED, flashing/steady light, one-sided red, without bracket	111 241-3
BakoLight LED, flashing/steady light, two-sided amber, without bracket	111 242-1

Accessories and Spare parts	Ref. No.
Bracket for mounting the MonoLight and BakoLight	070 877
Key	070 090-3

Running time with one battery set	
With battery Premium 800	one-sided steady light 250 hrs
	flashing light 750 hrs
With battery Konstant 25	two-sided steady light 300 hrs
	flashing light 900 hrs
With battery Premium 3000	one-sided steady light 500 hrs
	flashing light 1500 hrs
	two-sided steady light 1000 hrs
	flashing light 3000 hrs



**Packaging unit**  
10 pcs in one carton / 200 pcs on one pallet  
also available in other quantities



**More information**  
NIS-00074  
To be entered on nissen-germany.com

**Test number**  
V4-47-2004 V4-02-2004 V4-01-2004

# Euro-Nitra LED

- Easy attachment to tubes or barriers with the firmly mounted bracket
- Easy battery replacement without removing the lamp
- Automatic solar switch
- Useful loop for carrying or rapid attachment



**Light colour**  
amber oder red



**Eff. light intensity**  
amber one-sided 24 cd /  
two-sided 18 cd



**Eff. light intensity**  
red one-sided 22 cd /  
two-sided 20 cd



**Blink-/flash rate**  
60 fl./min.



**Dimensions (LxWxH)**  
195 x 90 x 350 mm



**Weight**  
0,7 kg

Euro-Nitra LED	Ref. No.
Euro-Nitra LED, flashing/steady light, one-sided amber, with bracket	112 127-51
Euro-Nitra LED, flashing/steady light, one-sided red, with bracket	112 127-53
Euro-Nitra LED, flashing/steady light, two-sided amber, with bracket	112 128-51
Euro-Nitra LED, flashing/steady light, two-sided red, with bracket	112 128-53

Accessories and Spare parts	Ref. No.
NiKo key	070 090-1
Pulser LED, one-sided amber	358 057-21
Pulser LED, one-sided red	358 057-23
Pulser LED, two-sided amber	358 058-21
Pulser LED, two-sided red	358 058-23



With bracket



NiKo key



Changing battery

Running time with one battery set	
With battery Premium 800	steady light 250 hrs
	flashing light 750 hrs
With battery Premium 3000	steady light 1500 hrs
	flashing light 4500 hrs



**Packaging unit**  
12 pcs in one carton / 240 pcs on one pallet  
also available in other quantities



**More information**  
NIS-00079  
To be entered on nissen-germany.com

**Test number**  
V4-80-2004 V4-117-2004 V4-120-2004



# Konstant-Norm LED

- Fits all beacon systems when using the appropriate adapter (42 mm Ø, 40 x 40 mm)
- Battery will be separately placed in base plate
- Automatic solar switch



**Light colour**  
amber



**Eff. light intensity**  
one-sided 30 cd /  
two-sided 16 cd



**Blink-/flash rate**  
60 fl./min.



**Dimensions (LxWxH)**  
207 x 88 x 270 mm



**Weight**  
0,6 kg

# MonoLight LED

- High-quality LEDs with nearly unlimited life time
- Only one battery needed
- Lamp head adjustable, with reflective rim
- Automatic solar switch
- Optional with firmly mounted bracket for attachment to vertical tubes



**Light colour**  
amber resp. red



**Eff. light intensity**  
two-sided 15 cd / omnidirectional 3  
cd



**Blink-/flash rate**  
60 - 70 fl./min.



**Dimensions (LxWxH)**  
without bracket 185 x 120 x 340 mm



**Weight**  
0,5 kg



On Safety Beacon



Locking bolt



Battery compartment

Konstant-Norm LED	Ref. No.
Konstant-Norm LED, flashing/steady light, one-sided amber	111 221-1
Konstant-Norm LED, flashing/steady light, two-sided amber	111 222-1
Accessories and Spare parts	Ref. No.
Pulser LED, one-sided amber	355 521-11
Pulser LED, two-sided amber	355 522-11

Running time with one battery set	
With battery Konstant 111	steady light 1550 hrs / flashing light 4600 hrs
With battery Konstant 110	steady light 1450 hrs / flashing light 4300 hrs

**Packaging unit**  
10 pcs in one carton / 250 pcs on one pallet  
also available in other quantities

**More information**  
NIS-00077  
To be entered on nissen-germany.com

**Test number**  
V4-121-2003 V4-120-2003



MonoLight LED	Ref. No.
MonoLight LED, flashing/steady light, two-sided amber, with bracket	111 602-51
MonoLight LED, flashing/steady light, two-sided red, with bracket	111 602-53
MonoLight LED, flashing/steady light, two-sided amber, without bracket	111 602-1
MonoLight LED, flashing/steady light, two-sided red, without bracket	111 602-3
MonoLight LED, flashing/steady light, omni-directional amber, without bracket	111 605-1
Accessories and Spare parts	Ref. No.
Bracket for mounting the MonoLight and BakoLight	070 877
NiKo key	070 090-1
NiKo bracket for mounting the MonoLight on barriers	365 519
Bracket for mounting the MonoLight on traffic cones	292 032-3

**Packaging unit**  
20 pcs in one carton / 400 pcs on one pallet  
also available in other quantities

**More information**  
NIS-00216  
To be entered on nissen-germany.com



MonoLight omni-directional



MonoLight with bracket



NiKo key



Changing battery

Running time with one battery set	
With battery Premium 800	steady light 300 hrs flashing light 1200 hrs
With battery Premium 3000	steady light 1150 hrs flashing light 4500 hrs

# Nitra LED

- Available with firmly mounted bracket or without bracket available
- Easy battery replacement without removing the lamp
- Use on folding triangles without additional holder
- Useful ring for carrying or rapid attachment
- Automatic solar switch
- With reflective rim



**Light colour**  
amber resp. red



**Eff. light intensity**  
15 cd



**Blink-/flash rate**  
60-70 fl./min.



**Dimensions (LxWxH)**  
185 x 90 x 350 mm



**Weight**  
0,6 kg



Nitra LED on folding traffic sign



NiKo key



Nitra LED with bracket

## Nitra LED Ref. No.

Nitra LED, flashing/steady light, two-sided amber, with bracket	111 520-51
Nitra LED, flashing/steady light, two-sided red, with bracket	111 520-53
Nitra LED, flashing/steady light, two-sided amber, without bracket	111 520-1
Nitra LED, flashing/steady light, two-sided red, without bracket	111 520-3

## Accessories and Spare parts Ref. No.

NiKo key	070 090-1
Pulser LED, two-sided amber	358 070-1
Pulser LED, two-sided red	358 070-3

## Running time with one battery set

With battery Premium 800	steady light 850 hrs flashing light 3400 hrs
With battery Premium 3000	steady light 2000 hrs flashing light 7000 hrs



**Packaging unit**  
12 pcs in one carton / 240 pcs on one pallet  
also available in other quantities



**More information**  
NIS-00189  
To be entered on nissen-germany.com

# Guide light systems



## Early reliable orientation

Nissen lighting systems are ideally suited for traffic management at work sites. Take advantage of our integrated solutions, which are characterized by a number of advantages.

### UNIVERSAL USAGE

Our products are suitable, for safety beacons, traffic cones, safety barriers and folding traffic signs

### OPTIMAL SYNCHRONIZATION

Via cable, infra-red or GPS

### TESTED ACCORDING TO STANDARDS

Lighting classes and management sequences depending on the country regulations

### MAXIMUM ENERGY EFFICIENCY

Long operating times thanks to highly developed lens and LED technology

### RELIABLE QUALITY

All solutions from our own development and production facilities

nissen  
DM RA1 A DIN 67520

# Sequential Direction Light Set

- Good visibility of the traffic guidance also at darkness by basic steady light
- Available as 10-fold or 5-fold system, sequence operation with several systems possible
- Fastening on any beacon type (42 mm Ø, 40 x 40 mm)
- Setting of the solar switch as needed
- Guide length of 100 m resp. 50 m per system
- For 230 V mains operation or 12 V battery operation, switching automatically at power failure
- Operation by foil-keyboard with LCD display



**Light colour**  
yellow



**Max. light intensity**  
Flashing light day: 2500 cd  
night: 700 cd



**Max. power consumption**  
at mains operation 230 V  
max. 1,5 A



**Weight**  
0,6 kg (single lamp)



**Light colour**  
yellow



**Eff. light intensity**  
1500 cd



**Aver. power consumpt. day**  
0,65 A



**Operating voltage**  
12/24 A



**Blink-/flash rate**  
60 fl./Min.



**Light source**  
1 LED



**Weight**  
0,6 kg (single lamp)

## Sequential Direction Light Set

Ref. No.

10-fold Sequential Direction Light Set Halogen Type 22/3, 230/12 V with power supply unit / charger 230 V and battery box, without beacons	120 910-1
5-fold Sequential Direction Light Set Halogen Type 22/3, 230/12 V with power supply unit / charger 230 V and battery box, without beacons	120 910-5
10-fold Sequential Direction Light Set Halogen Type 22/3, 12 V with battery box, without beacons	120 910-11

## Accessories and Spare parts

Ref. No.

Control unit 12 V, also for sequence operation	220 910-1
Box for rechargeable batteries 12 V up to 230 Ah, lockable	190 230-1
Mains supply / charger 230 V	220 909-1
Connecting cable 120 m for sequence operation	400 078-2
Halogen bulb type 026, 12 V / 20 W	090 234

## Running time with one battery set

With rechargeable battery 12 V, 180 Ah	1. Guide light 70 hrs
	2. Overlapping guide light 47 hrs
	3. Sequenced light 22 hrs
	4. Sequenced and declining light 22 hrs
	5. Flashing synchronous 40 hrs
	6. Flashing asynchronous 40 hrs
	7. Steady light 19 hrs



**More information**  
NIS-00349  
To be entered on nissen-germany.com



Box for rechargeable batteries



control unit 12 V

Test number  
US-2496N

# Cascade Light Set 200 LED

- Consisting of 1 master lamp and up to 9 slave lamps
- Robust cable plug connection between the single lamps
- With solar switch
- With bracket 82 mm Ø, suitable for most beacon types



**Light colour**  
yellow



**Eff. light intensity**  
1500 cd



**Aver. power consumpt. day**  
0,65 A



**Operating voltage**  
12/24 A



**Blink-/flash rate**  
60 fl./Min.



**Light source**  
1 LED



**Weight**  
0,6 kg (single lamp)

## Cascade Light Set 200 LED

Ref. No.

Cascade lamp 200 LED, yellow without beacons	122 216-01
--	------------

## Accessories and Spare parts

Ref. No.

Box for rechargeable batteries 12 V up to 230 Ah, lockable	190 230-1
--	-----------

## Running time with one battery set

With rechargeable battery 12 V, 100 Ah	5-fold system - 160 hrs
With rechargeable battery 12 V, 180 Ah	5-fold system - 280 hrs
With rechargeable battery 12 V, 230 Ah	5-fold system - 360 hrs



Fixation at a Standard Beacon



Box for recharge. battery, lockable



**More information**  
NIS-00896  
To be entered on nissen-germany.com

# BakoTaper LED-Flash

- Energy-efficient design with only one LED
- Suitable as single lamp or guide light system
- Stable synchronization by long infrared path of up to 10 m
- Steady basic light for better orientation switchable
- Simple assembling on safety barriers and beacons (42 mm Ø, 40 x 40 mm)



**Light colour**  
yellow



**Eff. light intensity**  
270 cd / 135 cd



**Blink-/flash rate**  
60 fl./min.



**Light source**  
1 LED



**Weight**  
0,8 kg



**Light colour**  
yellow



**Eff. light intensity**  
100 cd (626-C)  
200 cd (626-C Plus L8L)



**Blink-/flash rate**  
60 fl./min.



**Light source**  
1 LED



**Weight**  
0,7 kg

## BakoTaper LED-Flash Ref. No.

BakoTaper Type 628 LED-Flash Guide Light, one-sided amber 129 084-1

## Accessories and Spare parts Ref. No.

Key 070 090-3

## Running time with one battery set

With battery Premium 800	day + night 300 hrs / night only 500 hrs
With battery Premium 3000	day + night 770 hrs / night only 1250 hrs
With battery Konstant 45	day + night 1400 hrs / night only 1600 hrs



BakoTaper LED-Flash Guide Light System



**Packaging unit**  
10 pcs in one carton  
also available in other quantities



**More information**  
NIS-01049  
To be entered on nissen-germany.com

# TaperLamp 626-C / 626-C Plus LED

- Tested according to British Standards (626-C)
- Integrated cone bracket
- Suitable as single lamp or guide light system
- Stable synchronization by infrared path of up to 10 m
- Steady basic light for better orientation
- Automatic switch-on by putting on a cone
- Lense with reflecting frame



**Light colour**  
yellow



**Eff. light intensity**  
100 cd (626-C)  
200 cd (626-C Plus L8L)



**Blink-/flash rate**  
60 fl./min.



**Light source**  
1 LED



**Weight**  
0,7 kg

## TaperLamp 626-C / 626-C Plus LED Ref. No.

TaperLamp 626-C LED FüQ Lamp, one-sided amber with cone bracket 129 083-1

TaperLamp 626-C Plus LED FüQ Lamp, one-sided amber with cone bracket 129 083-11

## Running time with one battery set

With battery Premium 800	(626-C) 600 hrs (626-C Plus) 300 hrs
With battery Premium 3000	(626-C) 2400 hrs (626-C Plus) 1200 hrs
With battery Konstant 45	(626-C) 4000 hrs



Changing battery



Holder



**Packaging unit**  
10 pcs in one carton / 200 pcs on one pallet  
also available in other quantities



**More information**  
NIS-00384  
To be entered on nissen-germany.com

# Rapid securing

## Security in hand rotation

In the case of short-term road safety, every second counts – especially when it comes to dangerous situations. Nissen has developed solutions that have been tried and tested worldwide by police departments, fire brigades and the German Federal Agency for Technical Relief (THW), as well as road maintenance companies.

### **READY FOR IMMEDIATE USE**

Protect hazardous areas quickly and easily

### **UNIVERSAL USAGE**

Stand alone or in combination with traffic cones

### **WIDE SPECTRUM**

Single lamps and guide lighting systems

### **MAXIMUM ENERGY EFFICIENCY**

Long operating times thanks to highly developed lens and LED technology

### **RELIABLE QUALITY**

All solutions from our own development and production facilities

# City Flash 63/S LED

- Rapid use lamp with high light intensity
- Switchable solar switch for use at night only or at day and night
- Attachment to tubes and barriers by theft-proof NiKo bracket (accessory)



# Star-Flash LED 610

- High flash intensity at day and night, effective especially at poor sight
- Switching on by external, rain-protected switch
- Use on folding traffic signs without additional adapter or on traffic cones with adapter
- Attachment to tubes and barriers by theft-proof NiKo bracket (accessory)



**Light colour**  
yellow



**Eff. light intensity**  
260 cd



**Blink-/flash rate**  
60 fl./min.



**Dimensions (LxWxH)**  
370 x 205 x 95 mm



**Weight**  
0,7 kg



**Light colour**  
yellow



**Eff. light intensity**  
330 cd



**Blink-/flash rate**  
60 fl./min.



**Dimensions (LxWxH)**  
370 x 205 x 95 mm



**Weight**  
0,7 kg

## City Flash 63/S LED Ref. No.

City Flash 63/S LED, one-sided amber	130 518-51
City Flash 63/S LED, two-sided amber	130 519-51

## Accessories and Spare parts Ref. No.

NiKo key	070 090-1
Adapter for using the Nitra, Euro-Nitra, Star-Flash and City Flash on traffic cones	081 736-1
NiKo bracket for attachment to vertical tubes	365 516-1
Set consisting of	365 516-2
10 NiKo brackets 365 516-1 and 1 NiKo key 70 090-1	
NiKo bracket for attachment to steel barrier frames	365 517-1
Set consisting of	365 517-2
10 NiKo brackets 365 517-1 and 1 NiKo key 70 090-1	

## Running time with one battery set

With battery Premium 800 one-sided 300 hrs

With battery Konstant 45 one-sided 1000 hrs



**Packaging unit**  
12 pcs in one carton / 240 pcs on one pallet  
also available in other quantities



**More information**  
NIS-00392  
To be entered on nissen-germany.com



Lamp with NiKo bracket



Adapter for traffic cones

## Star-Flash LED 610 Ref. No.

Star-Flash LED 610, one-sided amber	130 522-51
Star-Flash LED 610, two-sided amber	130 523-51

## Accessories and Spare parts Ref. No.

NiKo key	070 090-1
NiKo bracket for attachment to vertical tubes	365 516-1
Set consisting of	365 516-2
10 NiKo brackets 365 516-1 and 1 NiKo key 70 090-1	
NiKo bracket for attachment to steel barrier frames	365 517-1
Set consisting of	365 517-2
10 NiKo brackets 365 517-1 and 1 NiKo key 70 090-1	

## Running time with one battery set

With battery Premium 800 one-sided 360 hrs

With battery Konstant 45 one-sided 1200 hrs



**Packaging unit**  
12 pcs in one carton / 240 pcs on one pallet  
also available in other quantities



**More information**  
NIS-01073  
To be entered on nissen-germany.com



Lamp with NiKo bracket



Adapter for traffic cones

# Star-Flash LED 620

- Only one LED, therefore low current consumption and long operating times
- Automatic day/night adaptation
- Basic steady light for increased visibility at darkness
- Optionally with transport- and charging cradle, freely expandable
- With four swivel-out support feet, therefore high stability
- Space-saving storage due to slim design



# Star-Flash LED Type 627

- Synchronization by infrared diodes in each lamp
- Lamp chain of any length and any amount of lamps possible
- Energy-efficient design with only one LED
- Automatic switchover due to discharged rechargeable battery
- High stability by four swivel-out support feet
- Space-saving storage due to slim design



<b>Light colour</b> amber	<b>Eff. light intensity day / night</b> 500 cd / 250 cd	<b>Blink-/flash rate</b> 60 fl./min.	<b>Light source</b> 1 resp. 2 LED
<b>Dimensions (LxWxH)</b> 370 x 205 x 95 mm	<b>Weight</b> ca. 1,8 kg		

<b>Light colour</b> amber	<b>Eff. light intensity day / night</b> 500 cd / 250 cd	<b>Blink-/flash rate</b> 60 fl./min.	<b>Light source</b> one-sided: 1 LED / two-sided: 2 LED
<b>Dimensions (LxWxH)</b> 370 x 205 x 95 mm	<b>Weight</b> ca. 1,6 kg		

Star-Flash LED 620	Ref. No.
Star-Flash LED 620 A, one-sided amber housing colour yellow, bottom and lock black, with integrated lithium ferro battery pack	129 092-001-01
Star-Flash LED 620 A, two-sided amber housing colour yellow, bottom and lock black with integrated lithium ferro battery pack	129 092-001-02
Star-Flash LED 620 B, one-sided amber housing colour yellow, bottom and lock black for battery operation, without battery	129 092-011-01

Accessories and Spare parts	Ref. No.
Transport and charging cradle 12/24 V for Star-Flash LED Type 620/627, single, without supply cable	129 090-001-00
Transport and charging cradle 12/24 V for Star-Flash LED Type 620/627, single, with 2 m supply cable and 2-pole vehicle plug	129 090-001-01
Transport and charging cradle 12/24 V for Star-Flash LED Type 620/627, 4-fold, with 2 m supply cable and 2-pole vehicle plug	129 090-004-01
AC/DC converter 110-240V, 12V, 5A, for indoor use only, with cigarette lighter socket (for Star-Flash LED 620/627 A)	070 098-1



In transport and charging cradle



1-fold transport and charging cradle



4-fold transport and charging cradle

Running time with one battery set	
With integrated Lithium-Ferro rechargeable battery pack	40 hrs
With battery Premium 800	180 hrs

Star-Flash LED Type 627	Ref. No.
Star-Flash LED Type 627 A guide light lamp, one-sided amber (According to German Standards)	129 091-001-01
with integrated lithium-ferro battery pack	129 091-001-02
Star-Flash LED Type 627 A guide light lamp, two-sided amber, with integrated lithium-ferro battery pack	129 091-001-03
Star-Flash LED Type 627 A guide light lamp, one-sided blue (According to German Standards)	129 091-011-01
with integrated lithium-ferro battery pack	129 091-011-02
Star-Flash LED Type 627 B guide light lamp, one-sided amber (According to German Standards), for battery operation, without battery	
Star-Flash LED Type 627 B guide light lamp, two-sided amber for battery operation, without battery	

Each consisting of:  
Housing colour yellow, bottom and lock black, without transport and charging cradle

Accessories and Spare parts	Ref. No.
Transport and charging cradle 12/24 V for Star-Flash LED Type 620/627, single, without supply cable	129 090-001-00
Transport and charging cradle 12/24 V for Star-Flash LED Type 620/627, single, with 2 m supply cable and 2-pole vehicle plug	129 090-001-01
Transport and charging cradle 12/24 V for Star-Flash LED Type 620/627, 4-fold, with 2 m supply cable and 2-pole vehicle plug	129 090-004-01
AC/DC converter 110-240V, 12V, 5A, for indoor use only, with cigarette lighter socket (for Star-Flash LED 620/627 A)	070 098-1



In transport and charging cradle



Guide light



4-fold transport and charging cradle

Running time with one battery set	
With integrated Lithium-Ferro rechargeable battery pack	40 hrs
With battery Premium 800	180 hrs



# Pin Lamp LED Type 62/S

- For use in traffic cones 500 mm and 750 mm
- High light intensity
- Double warning effect due to traffic cone and active LED light
- For operation with mono cells or rechargeable battery cells (6 cells each lamp)



Light colour  
yellow



Eff. light intensity  
200 cd



Aver. power consumption  
0,035 A



Operating voltage  
9V



Light source  
1 LED



Weight  
0,8 kg

## Pin Lamp LED Type 62/S

Ref. No.

Pin Lamp LED Type 62/S, one-sided, yellow, without cone	130 351-51
Pin Lamp LED Type 62/S, two-sided, yellow, without cone	130 361-51

## Accessories and Spare parts

Ref. No.

Mono Cell, alkaline, 1,5V	155 007
Nickel Cadmium Cell	156 020
Charger for nickel cadmium rechargeable batteries (1 charger per lamp)	161 060-1

## Running time with one battery set

With mono cell, alkaline, 1,5V	2000 hrs
With nickel cadmium cell	250 hrs



Pin Lamp LED Type 62/S



Pin Lamp LED Type 62/S in a traffic cone



Packaging unit  
5 pcs in one carton / 125 pcs on one pallet  
also available in other quantities



More information  
NIS-00945  
To be entered on nissen-germany.com

# Traffic Cone Lamp Type 620-LK

- To be integrated in traffic cones 750 mm
- High flash intensity, with automatic day/night adaptation
- Better recognition due to additional steady light at night
- Battery level indication in the lamp head
- Double warning effect due to traffic cone and active LED light
- High stability due to low centre of gravity
- For operation with 4 dry cell batteries



Light colour  
yellow



Eff. light intensity day  
500 cd



Aver. power consumpt. day  
0,05 A



Operating voltage  
6V



Light source  
1 LED



Weight  
1,8 kg

## Traffic Cone Lamp Type 620-LK

Ref. No.

Traffic Cone Lamp Type 620-LK, 6 V, one-sided amber without traffic cone	130 304-51
Traffic Cone Lamp type 620-LK, 6 V, two-sided amber without traffic cone	130 314-51

## Accessories and Spare parts

Ref. No.

Dry Cell Battery Premium 800, 6V, 7 Ah – 9 Ah	155 051
Battery Premium 3000, 6 V, 28 - 30 Ah	155 053
Battery Konstant 45, 6 V, 45-50 Ah	155 056

## Running time with one battery set

With battery Premium 800	one-sided 700 hrs / two-sided 350 hrs
With battery Premium 3000	one-sided 3200 hrs / two-sided 1600 hrs
With battery Konstant 45	one-sided 4500 hrs / two-sided 2200 hrs



Packaging unit  
1 pcs in one carton



More information  
NIS-01645  
To be entered on nissen-germany.com



Suitable for traffic cone 750 mm

Test number  
V3-014-2016

# Traffic Cone Lamp 220 LED

- To be integrated in traffic cones 750 mm
- Double warning effect due to traffic cone and active LED light
- With automatic day/night adaptation
- Low current consumption due to the use of LED
- For operation with 4 dry cell batteries
- Complete lamp firmly connected with the traffic cone
- High stability due to low centre of gravity

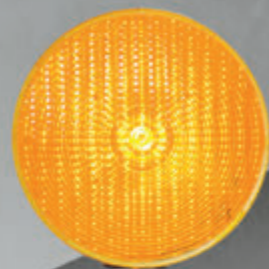

Light colour  
yellow



Eff. light intensity  
1500 cd



Aver. power consumpt. day  
0,14 A



Operating voltage  
12V



Light source  
1 LED



Weight  
1,8 kg

## Traffic Cone Lamp 220 LED

Ref. No.

Traffic Cone Lamp 220 LED, 12V, one-sided amber  
without traffic cone

130 322-1

## Accessories and Spare parts

Ref. No.

Dry Cell Battery Premium 800, 6V, 7 Ah – 9 Ah  
Battery Premium 3000, 6V, 28 – 30 Ah

155 051  
155 053

## Running time with one battery set

With battery Premium 800 110 hrs  
With battery Premium 3000 450 hrs

**Packaging unit**  
1 pcs in one carton  
also available in other quantities

**More information**  
NIS-01082  
To be entered on nissen-germany.com

**Test number**  
V4-54-2006



Suitable for traffic cone 750 mm

# Traffic Cone Lamp 340 LED

- For use in traffic cones of 750 mm and 1000 mm height
- With 4 LED, therefore effective warning even at poor sight
- Double warning effect due to traffic cone and active LED light
- Low power consumption
- Lamp head connected to the base by stable adjustable tube,  
therefore no bending of the cone in hot weather
- High stability due to low centre of gravity



Light colour  
yellow



Eff. light intensity  
8000 cd



Aver. power consumpt. day  
0,25 A



Operating voltage  
12V



Light source  
4 LED



Weight  
4,1 kg

## Traffic Cone Lamp 340 LED

Ref. No.

Traffic Cone Lamp 340 LED, one-sided amber, without traffic cone

130 323-1

## Accessories and Spare parts

Ref. No.

Dry Cell Battery Premium 800, 6V, 7 Ah – 9 Ah  
Battery Premium 3000, 6V, 28 – 30 Ah  
Battery Konstant 45, 6V, 45-50 Ah

155 051  
155 053  
155 056

## Running time with one battery set

With battery Premium 800 90 hrs  
With battery Premium 3000 370 hrs  
With battery Konstant 45 600 hrs

**Packaging unit**  
1 pcs in one carton  
also available in other quantities

**More information**  
NIS-00835  
To be entered on nissen-germany.com



High-adjustable tube for 1000 and 750 mm traffic cones

# Traffic Cone Lamp Type S-LED

- High brightness
- Double warning effect due to traffic cone and active LED light
- For use on traffic cones
- Easy mounting by special adapter (accessory) for firm connection with the traffic cone
- Replacement of battery also possible when mounted on a cone
- Particularly suitable for long operating times
- Only one battery needed



**Light colour**  
yellow



**Eff. light intensity**  
250 cd



**Aver. power consumption**  
0,025 A



**Operating voltage**  
6V



**Light source**  
1 LED



**Weight**  
0,8 kg

# Synchros

- Early recognition of danger spots
- Synchronized light sequence to ensure safe passing of the hazardous spot
- Space saving placement in compact storage and charging box
- Charger cable with 2-pole vehicle plug



**Light colour**  
yellow or blue



**Aperture angle**  
horizontal / vertical 15°



**Operating voltage**  
10 - 30 V DC



**Aver. power consumption**  
with completely discharged battery 0,5 A



**Operation time**  
ca. 16 hrs



**Dimensions (LxWxH)**  
LED guide light element  
100 x 90 x 25 mm



**Dimensions (LxWxH)**  
transport and storage case  
260 x 160 x 125 mm



**Weight**  
2,5 kg

## Traffic Cone Lamp Type S-LED

Ref. No.

Traffic Cone Lamp Type S-LED, 6V, one-sided amber without traffic cone

130 340-1

## Accessories and Spare parts

Ref. No.

Special adapter for use on traffic cones, cpl.

381 736-2

## Running time with one battery set

With battery Premium 800	300 hrs
With battery Premium 3000	1200 hrs
With battery Konstant 45	2000 hrs



Special adapter 381 736-2

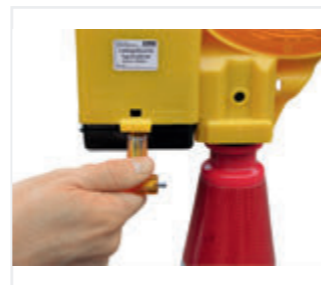

Changing battery

## Synchros

Ref. No.

Mobile LED Sequential Hazard Set 12/24V, yellow, cpl.  
Mobile LED Sequential Hazard Set 12/24V, blue, cpl.  
each set consisting of:  
5 LED guide light elements yellow resp. blue  
1 transport and charging box with  
1 charging cable with 2-pole vehicle plug

141 060-1

## Accessories and Spare parts

Ref. No.

Mains charger for 230 V  
Mains charger, UK version (not illustrated)  
Guide light element yellow for Synchros  
Guide light element blue for Synchros  
Charging cable for Synchros with straight plug

070 157-1  
070 157-2  
241 060-1  
241 060-2  
400 225-2



Single element



Blue version



Charging cable



Mains charger

**Packaging unit**  
1 pcs in one carton  
also available in other quantities

**More information**  
NIS-00422  
To be entered on nissen-germany.com

**More information**  
NIS-00386  
To be entered on nissen-germany.com

# Advance warning lamps



220 mm

BASt approved  
according to "TL-Warnleuchten"  
**WL6**

Lamp class  
**L8H  
L8M**  
according to EN12352



340 mm

BASt approved  
according to "TL-Warnleuchten"  
**WL5  
WL7**

Lamp class  
**L9H  
L9M**  
according to EN12352

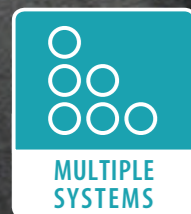

# Advance Warning Lamp Zyklop 220

- Energy-efficient design with only one LED
- Automatic day/night adaptation, switchable to solar switch
- 5 m connecting cable with battery clips
- With bracket for tubes up to 82 mm



Light colour  
yellow



Eff. light intensity  
1500 cd



Aver. power consumpt. day  
0,15 A



Operating voltage  
12/24V



Blink-/flash rate  
60 fl./min.



Light source  
1 LED



Weight  
0,6 kg

## Advance Warning Lamp Zyklop 220

Ref. No.

Advance Warning Lamp Zyklop 220, 12/24 V, with 5 m connecting cable with battery clips, without bracket, multiple systems also available

122 221-1-02

## Accessories and Spare parts

Ref. No.

Box for rechargeable batteries 12V up to 230 Ah, lockable

190 230-1

Bracket for tubes up to 82 mm

365 522-12

## Running time with one battery set

With rechargeable battery 12 V, 100 Ah	880 hrs
With rechargeable battery 12 V, 180 Ah	1600 hrs
With rechargeable battery 12 V, 230 Ah	2000 hrs



Advanced Warning Lamp with bracket



Box for rechargeable batteries

# Advance Warning Lamp Zyklop 220 Flash

- Energy-efficient design with only one LED
- Automatic day/night adaptation
- 5 m connecting cable with battery clips



Light colour  
yellow



Eff. light intensity  
500 cd



Aver. power consumpt. day  
0,04 A



Blink-/flash rate  
60 fl./min.



Operating voltage  
12/24V



Light source  
1 LED



Weight  
0,6 kg

## Advance Warning Lamp Zyklop 220 Flash

Ref. No.

Advance Warning Lamp Zyklop 220 Flash, 12/24 V, with 5 m connecting cable with battery clips, without bracket, multiple systems also available

122 221-201

## Accessories and Spare parts

Ref. No.

Box for rechargeable batteries 12V up to 230 Ah, lockable

190 230-1

Bracket for tubes up to 82 mm

365 522-12

## Running time with one battery set

With rechargeable battery 12 V, 100 Ah	3000 hrs
--	----------



Advanced Warning Lamp with bracket



Box for rechargeable batteries

# Advance Warning Lamp 340 LED L9H

- Energy-efficient LED technology
- Automatic day/night adaptation, switchable to solar switch
- 5 m connecting cable with battery clips
- With bracket for tubes up to 82 mm



Light colour  
yellow



Eff. light intensity day  
20000 cd



Aver. power consumpt. day  
0,4 A



Operating voltage  
12/24V  
230V



Blink-/flash rate  
60 fl./min.



Light source  
4 LED



Weight  
2,7 kg

## Advance Warning Lamp 340 LED L9H

Ref. No.

Advance Warning 340 LED L9H, 12/24V, 5 m connecting cable with battery clips with bracket, multiple systems also available 122 315-1

Advance warning lamp 340 LED L9H, 230V, with 5 m connecting cable with bracket, multiple systems also available 122 311-51

## Accessories and Spare parts

Ref. No.

Bracket for mounting 340 mm lamps on tubes 070 753

Box for rechargeable batteries 12 V up to 230 Ah, lockable 190 230-1

## Running time with one battery set

With rechargeable battery 12 V, 180 Ah 700 hrs

With rechargeable battery 12 V, 100 Ah 300 hrs



Advanced Warning Lamp with bracket



Box for rechargeable batteries



More information  
NIS-00543  
To be entered on nissen-germany.com

Test number  
V4-59-2011

# Advance Warning Lamp 340 LED Flash L9M

- Energy-efficient LED technology
- Automatic day/night adaptation, switchable to solar switch
- 5 m connecting cable with battery clips
- With bracket for tubes up to 82 mm



Light colour  
yellow



Eff. light intensity day  
4900 cd



Aver. power consumpt. day  
0,05 A



Operating voltage  
12/24V



Blink-/flash rate  
60 fl./min.



Light source  
4 LED



Weight  
2,7 kg

## Advance Warning Lamp 340 LED Flash L9M

Ref. No.

Advance Warning Lamp 340 LED Flash L9M, 12/24 V, with bracket and 5 m connecting cable with battery clips multiple systems also available 122 311-201

## Accessories and Spare parts

Ref. No.

Bracket for mounting 340 mm lamps on tubes 070 753

Box for rechargeable batteries 12 V up to 230 Ah, lockable 190 230-1

## Running time with one battery set

With rechargeable battery 12 V, 180 Ah 3000 hrs

With rechargeable battery 12 V, 100 Ah 1500 hrs



Advanced Warning Lamp with bracket



Box for rechargeable batteries



More information  
NIS-00795  
To be entered on nissen-germany.com

Test number  
V4-70-2011

# Lighting system LZA 500

## Flexible in use

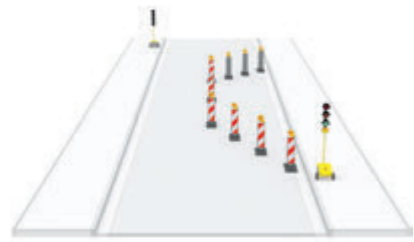

Fixed time control

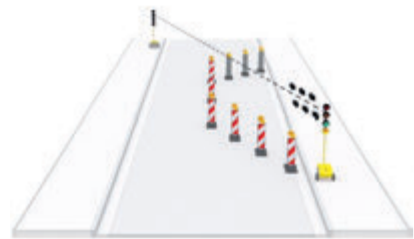

Fixed time control with radio

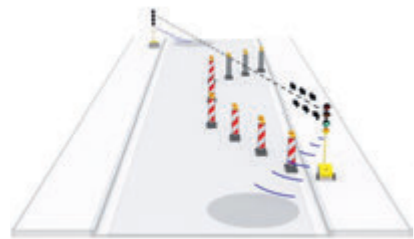

Traffic-dependent with radio

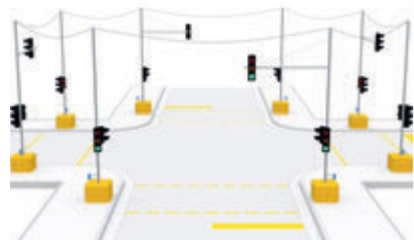

Intersection with radio and cable\*



1480 mm

800 mm

2800 mm

2310 mm



590 mm

\* Requires specialized approval



# Traffic Light System LZA 500-LED

- Compact and handy design
- Country specific programs and languages selectable
- Preprogrammed program sequences selectable
- Programming wizard for individual program sequences
- Traffic-dependent control system
- Connections for cable operation as standard
- Radio remote control for all features
- Imitator operation
- External in- and output
- Request on demand



**Light colour**  
red, yellow, green



**Max. light intensity**  
380 cd red, 360 cd yellow,  
160 cd green



**Aver. power consumpt. day**  
0,45 A



**Operating voltage**  
12V



**Light source**  
80 high power LED

# LED-Counter for LZA 500-LED

- Decrementer for traffic light systems
- Counting down during the whole red phase
- No special adjustments necessary
- Clearly visible LED display, integrated into the yellow lamp chamber (height of text ca. 140 mm)
- Connection and supply directly by the LZA 500
- Low power consumption



**Light colour**  
red



**Max. light intensity**  
280 cd red



**Max. power consumption day**  
0,5 A



**Operating voltage**  
12V

LED-Counter for LZA 500-LED

Ref. No.

LED-Counter for LZA 500-LED

245 602-11

## Traffic Light System LZA 500-LED

Ref. No.

Quartz LZA 500-LED	145 562-151
2 signal transmitters with sunshades, 2 carriages and 1 pilot	
Quartz LZA 500-LED with radio report, 869 MHz	145 562-353
2 signal transmitters with sunshades, 2 carriages, 1 pilot and 2 radio modules	
Quartz LZA 500-LED FVG/FVA with radio report and radar sensors for traffic-dependent operation, 869 MHz	145 562-355
2 signal transmitters with sunshades, 2 carriages, 1 pilot and 2 radio modules	

## Accessories and Spare parts

Ref. No.

100 m signal transmitter connection cable for cable operation	400 227-1
Contrast shield	080 158-1

## Running time with one battery set

With rechargeable battery 12V, 180 Ah	550 hrs
With rechargeable battery 12V, 230 Ah	700 hrs



Radar sensor



Control panel



Contrast shield



Transport position

**More information**  
NIS-00832  
To be entered on nissen-germany.com

**Test number**  
Ni-0812008

**More information**  
NIS-00833  
To be entered on nissen-germany.com



# Hand lamps

## High performance in a hand-held format

The king of flash lamps: Nissen hand lamps are standard for emergency personnel at work sites. The robust technology and the extremely resistant housings have proven themselves in daily use for decades. There's no improving on a classic – choose Nissen hand lamps.



# Hand Lamp LED

- Ideal for working and warning purposes
- Adjustable lamphead
- Excellent illumination of the nearby area
- Shock-proof plastic case



**Light colour**  
white or coloured disc



**Blink-/flash rate**  
60 fl./min.



**Dimensions (LxWxH)**  
180 x 80 x 290 mm



**Weight**  
0,5 kg

## Hand Lamp LED

**Ref. No.**

Hand Lamp LED, flashing/steady light switchable

140 261-1

## Accessories and Spare parts

**Ref. No.**

Red disc	270 910
Yellow disc	270 920
Green disc	270 930
Blue disc	270 940

## Running time with one battery set

With battery Premium 800      steady light 100 hrs / flashing light 300 hrs



Ajustable lamp head



Hand lamp discs



**More information**  
NIS-01188  
To be entered on nissen-germany.com

# Hand Lamp halogen

- Ideal for working and warning purposes
- Sight of up to 500 m, sufficient ambient light
- Shock-proof plastic case
- Adjustable lamphead



**Light colour**  
white or coloured disc



**Max. light intensity**  
without disc 4100 cd



**Blink-/flash rate**  
60 fl./min.



**Dimensions (LxWxH)**  
180 x 80 x 290 mm



**Weight**  
0,5 kg

## Hand Lamp halogen

**Ref. No.**

Hand Lamp, steady light only	140 250-2
Hand Lamp, flashing/steady light switchable	140 260-2

## Accessories and Spare parts

**Ref. No.**

Halogen bulb type 054, 6V / 0,5 A, plug-type socket	090 263-2
Red disc	270 910
Yellow disc	270 920
Green disc	270 930
Blue disc	270 940

## Running time with one battery set

With battery Premium 800	steady light 80 hrs / flashing light 250 hrs
With battery Premium 3000	steady light 120 hrs / flashing light 390 hrs



Ajustable lamp head



Hand lamp discs



**More information**  
NIS-00506  
To be entered on nissen-germany.com

# Batteries and rechargeable batteries



## Safe power supply

Lamps and systems for traffic safety require both powerful and reliable batteries and rechargeable batteries. Our models offer you excellent performance and are characterized by excellent cold-resistance and environmentally friendliness.

For lights		For large devices	
Premium 800	6 V, 7-9 Ah	Lead-gel battery	12 V, 80 Ah 12 V, 140 Ah 12 V, 210 Ah
Konstant 25	6 V, 25-28 Ah	Lead-acid battery	12 V, 100 Ah 12 V, 180 Ah 12 V, 230 Ah
Konstant 45	6 V, 45-50 Ah		
Konstant 60	6 V, 60 Ah		
Konstant 111	6 V, 120 Ah		

# Premium 800 Batteries

- Antipollution
- Without mercury or cadmium
- High cold resistance



**Dimensions (LxWxH)**  
67 x 98 x 67 mm



**Weight**  
Premium 800: 0,45 kg

## Premium 800 Batteries

## Ref. No.

Dry Cell Battery Premium 800, 6 V, 7 - 9 Ah

155 051



**Packaging unit**  
Premium 800: 20 pcs/carton - 1600 pcs/pallet  
also available in other quantities



**More information**  
NIS-00744  
To be entered on nissen-germany.com

# Konstant Batteries

- Constant discharge, therefore steady brightness of the warning lamps
- Exceptionally long operating times
- Cold resistant down to - 25° C
- Free of cadmium and mercury



**Dimensions (LxWxH)**  
Konstant 25: 67 x 98 x 67 mm



**Dimensions (LxWxH)**  
Konstant 45: 67 x 98 x 67 mm



**Dimensions (LxWxH)**  
Konstant 60: 160 x 75 x 130 mm



**Dimensions (LxWxH)**  
Konstant 111: 160 x 75 x 130 mm



**Weight**  
Konstant 25: 0,53 kg



**Weight**  
Konstant 45: 0,68 kg



**Weight**  
Konstant 60: 1,14 kg



**Weight**  
Konstant 111: 1,43 kg

## Konstant Batteries

## Ref. No.

Battery Konstant 25, 6 V, 25-28 Ah

155 054

Battery Konstant 45, 6 V, 45-50 Ah

155 056

Battery Konstant 60, 6 V, 60 Ah

155 057

Battery Konstant 111, 6 V, 120 Ah

155 065



**Packaging unit**  
Konstant 25 / Konstant 45: 12 pcs/carton - 1152 pcs/pallet  
Konstant 60: 10 pcs/carton - 540 batteries on one pallet  
Konstant 111: 10 batteries in one carton - 540 pcs/pallet  
also available in other quantities



**More information**  
NIS-00773  
To be entered on nissen-germany.com



Konstant 111 in base plate

# Rechargeable Batteries and Batteries

- For Mobile Warning Trailers
- For VarioSign LED-System
- For traffic light system LZA 500
- For advance warning lamps



# Chargers for Batteries

- For Mobile Warning Trailers
- For VarioSign LED-System
- For traffic light system LZA 500
- For advance warning lamps, hand lamp and traffic cone lamps
- For guide light systems
- For Synchros



161 060-1

## Rechargeable Batteries and Batteries

	Ref. No.
Monocell alkaline, 1,5 V	155 007
Ø 330 x 610 mm (H), 0,14 kg, 85 St./carton	
Nickel Cadmium Cell	156 020
Ø 320 x 600 mm (H), 0,12 kg, 10 St./carton	
Lead Acid Rechargeable Battery (drive battery) 12 V, 100 Ah	165 340-2
350 x 175 x 190 mm (LxWxH) 27 kg, 36 pcs/pallet	
Lead Acid Rechargeable Battery (drive battery) 12 V, 180 Ah	165 330
518 x 223 x 223 mm (LxBxH), 48 kg, 21 pcs/pallet	
Lead Acid Rechargeable Battery (drive battery) 12 V, 230 Ah	165 331-1
520 x 280 x 250 mm (LxWxH), 63 kg, 18 pcs/pallet	
Lead Gel Rechargeable Battery (drive battery) 12 V, 80 Ah	165 333-1
350 x 175 x 190 (LxWxH), 26 kg, 48 pcs/pallet	
Lead Gel Rechargeable Battery (drive battery) 12 V, 140 Ah	165 335
513 x 223 x 225mm (LxWxH), 48,5 kg, 21 pcs/pallet	
Lead Gel Rechargeable Battery (drive battery) 12 V, 210 Ah	165 338
515 x 227 x 215 mm (LxWxH), 63 kg, 18 pcs/pallet	

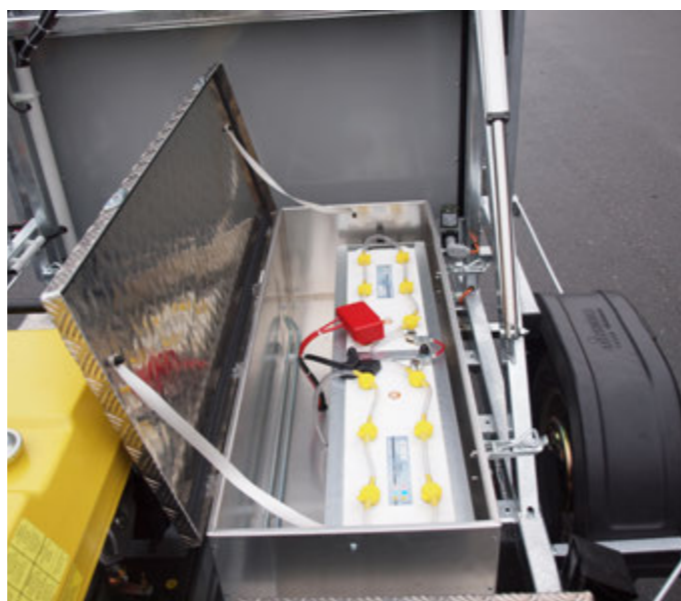

## Chargers for Batteries

	Ref. No.
Charger for nickel cadmium rechargeable batteries (1 charger per lamp)	161 060-1
Charger 12 V, 17 A, IP65	070 074-17
Charger 230/12 V, 30 A, IP67	070 074-31
Built-in charger 12/24 V, 35 A, IP44	070 075-35



Charger



Charger 12 V, 17 A



Charger 230/12 V, 30 A



Built-in charger

A long-exposure photograph of a multi-lane highway at night. The image shows vibrant light trails from cars, with yellow and white streaks for headlights and red streaks for taillights. In the background, several tall office buildings are lit up, their windows glowing against the dark sky. A red diagonal graphic element is present in the top-left and bottom-right corners of the page.

## Imprint

**Edition** January 2018

**Publisher**

Adolf Nissen Elektrobau GmbH + Co. KG,  
Friedrichstädter Chaussee 4, 25832 Tönning

**Concept and design**

mlv Werbeagentur GmbH, Hamburg

**Press head**

Lehmann Offsetdruck und Verlag GmbH,  
Norderstedt

## Disclaimer

This information is subject to technical changes and errors. Pictures can differ from the original product or accessories. All details are approximate. We supply all products without batteries or rechargeable batteries.

**Important:**

All products may only be installed and operated by trained personnel. Instructions for use, installation instructions and the relevant regulations must be observed strictly.

© Adolf Nissen Elektrobau GmbH + Co. KG 2018



**Adolf Nissen Elektrobau GmbH + Co. KG**

Friedrichstädter Chaussee 4  
25832 Tönning • Germany

T +49 4861 612 - 0  
F +49 4861 612 - 144

[vertrieb@nissen-germany.com](mailto:vertrieb@nissen-germany.com) (Germany)  
[export@nissen-germany.com](mailto:export@nissen-germany.com) (Worldwide)

[nissen-germany.com](http://nissen-germany.com)